

配电箱、柜系列

Box and Cabinet Series

产品手册

www.jsyineng.com



公司简介 COMPANY INTRODUCTION

江苏亿能电气集团位于江苏省扬中经济开发区,前身为成立于1986年的镇江市亿能电力器材有限公司。经过二十余年的发展,年生产能力超20亿元。集团产品遍及高低压成套电器设备、高低压母线、电缆桥架、金属套管、电加热器、船舶军工配套产品等6大系列产品。

江苏亿能电气集团秉持“科技、人文、责任”的核心价值观,全面推行信息化管理,实行企业架构下的品牌、质量、营销、研发等方面的统一管理。以全球化的视野、卓越的品质、周到的服务、高效的管理赢得了客户的青睐,并与Schneider、Eaton、GE、ABB签订了战略合作协议。集团产品被国家电网、中石油、中海油、国家开发银行、中国移动、中国联通、中国博览会会展中心、上海宝钢、葛洲坝水电站、渤海船舶重工、大连万达集团、碧桂园集团、长春一汽等国家重点项目和重大工程采用,深受客户好评。

江苏亿能电气集团是江苏省重点扶持的成长型企业、江苏省民营科技企业、镇江市文明单位、镇江市园林式单位、中国建设银行“AAA”级信用企业。集团先后通过了ISO9001质量管理体系认证,ISO14001环境管理体系认证、ISO18001职业健康认证、ISO10012测量管理体系认证、KEMA认证、国家强制性3C认证等认证,荣获了“国家重合同守信用企业”、“江苏省著名商标”、“江苏省名牌产品”、“国家高新技术企业”称号。

江苏亿能电气集团,秉承“科技彰显人文,责任成就未来”的企业宗旨,不断聚集中国顶尖水平的电气高新技术,汇集电气发展的精英才俊,全力打造系列化、多元化的优势产品,实现更大规模、更深层次地发展。“亿”气风发,能者为先,她正在向着打造中国电气行业著名企业的目标,阔步奋进、再创辉煌。



Jiangsu Yineng Electric Group is located in Yangzhong economic development zone. Zhenjiang Yineng Electric Equipment Company, founded in 1986, is the predecessor. With the development of nearly 30 years, the annual production capacity has exceeded 2 billion yuan. There are 5 subsidiary companies including Jiangsu Yineng Electric Co., Ltd., Zhenjiang Yitong Metal Tube Co., Ltd., Zhenjiang Jiatai Electric Co., Ltd., Zhenjiang Yiquan General Lighting and Busway Co., Ltd. and Zhenjiang Shengfa Electric Co., Ltd. There is a wide range of products in the group, such as high and low voltage switchgear, high and low voltage busway, cable tray, metal tube, electric heaters, ship military products and other accessory products.

The group upholds "Technology, Humanities, Responsibility" as the core value, implements information management comprehensive, unified manage the brand, quality, marketing and R&D of the enterprise. Yineng is highly appreciated by our customers for its globalization horizon, superior quality and thoughtful service, effective management. The group has signed the strategic cooperation agreement with Schneider, Eaton, GE and ABB. Our products have been adopted by the national key projects and major projects such as State Grid, China Mobile, Dong Fang Electric Cooperation, Shanghai Expo, Dalian Wanda Group, Anshan Iron And Steel Group Cooperation, Gezhouba Hydropower Plant, Bohai Shipping Heavy Industry co., Ltd. and so on.

Yineng Group is a key supported growing enterprise of Jiangsu Province, it is Jiangsu private technology enterprise, Zhenjiang City Civilization Unit, Zhenjiang City Garden Unit, it access to "AAA grade credit enterprise" of CC-BI and "re-contract and trustworthy enterprise" and other honorary titles. The group has got the ISO9001 Quality Management System Certification, ISO14001 Environmental Management System Certification, ISO10012 Measurement Management System Certification, KEMA, China Compulsory Certification (CCC). And the group has been awarded "Jiangsu Famous Trademark", "Jiangsu Brand-name product".

"Technology demonstrates the humanities, responsibility determines the future" is our corporate purposes, The group has been gathering the top electrical technology and talents of china, to full create seriation and diversification products for larger scale and deeper development. Yineng is walking towards the well-known Chinese enterprises in the electrical industry and it will stride ahead and create greater glories.



目录

机箱系列

Box series

- 2-3 精巧控制箱系列
smart control box series
- 4-5 接线箱系列
connection box series
- 6-8 不锈钢接线箱系列
stainless steel connection box series
- 9-10 挂壁箱系列
wall mounted box series
- 11-12 不锈钢挂壁箱系列
stainless steel wall mounted box series
- 13-14 立式控制箱系列
vertical control box series
- 15-17 不锈钢立式控制箱系列
stainless steel vertical control box series
- 18-19 豪华立式控制箱系列
luxury vertical control box series
- 20-21 不锈钢豪华立式控制箱系列
stainless steel luxury vertical control box series
- 22-22 铸铝接线盒
cast aluminum connection box



机柜系列

Cabinet series

- 24-28 独立式控制柜系列
stand-alone control cabinet series
- 29-30 组合柜系列
combined cabinet series
- 31-32 不锈钢独立式控制柜系列
stainless steel stand-alone control cabinet series



附录

Temperature control series

- 35-36 IP 防护等级 IP protection grade
- 37-38 喷涂工艺及应用 Spraying process and Application
- 39-39 产品材料性能 Product material properties
- 40-41 RAL 色卡 RAL color card



机箱系列 Box series

精巧控制箱系列

Smart control cabinet series



| | |
|--------------------------------|--|
| 材料 Material | 冷轧钢板 Cold rolled steel sheet |
| 表面处理 Surface treatment | 箱体和门板磷化浸涂处理， 外部为粉末涂层，颜色可分 RAL7032和RAL7035两种纹 路。安装板则为镀锌 板。安装板则为镀锌 板。Etch primer for box body and door plate; powder coating for outside; RAL7032 or RAL7035 textures optional; galvanized mounting plate |
| 防护等级 Protection grade | IP56(按GB4205-1993) IP56 (acc. to GB4205-1993) |
| 标准配置 Standard configuration | 门板、箱体、接地条、接地零件、 安装板、门锁 Door plate, box body, earthing strip, grounding set, mounting plate, door lock |
| 钢板厚度 Plate thickness | 箱体:1.2-1.5mm 门板:1.5mm 安装板:2.5mm Box body: 1.2-1.5mm Door plate: 1.5mm Mounting plate: 2.5mm |



专用锁系统
带双齿锁芯的专业锁系统
Special lock system
Professional lock
system with double-
teeth cylinder



旋转180° 锌合金铰链
180° zinc alloy hinge



安装板
Mounting plate

产品特点 Features of products

- 180度铰链确保门开启角度达到180度
- 箱口多层保护槽能起加固作用，不但能防止门板打开时脏物和水进入箱内，而且提供更大的箱口空间
- 镀锌钢板制成的安装板不但可以在箱外做布线使用，并提供更大的安装空间
- PU发泡密封条确保箱体达到IP56的防护等级
- The 180° hinge to ensure that the door opening Angle of 180°
- The opening of the cabinet multilayer protection slot can be a role of reinforce, not only can prevent dirt and water into the cabinet when door open, but also supply the bigger cabinet opening space.
- The mounting plate made of galvanized steel not only can be used for wiring outside the cabinet, but also supply the bigger space of the cabinet installation.
- The PU foam sealing strip ensures the cabinet in the IP56 protection grade.

系列订货规格表

Series order specification table

| 序号 No. | 订货号(EB) Order number (EB) | 订货号(EB) Order number (EB) | 宽度 Width | 高度 Height | 深度 Depth |
|-----------|------------------------------|------------------------------|-------------|--------------|-------------|
| 1 | 00151508600 | 00151508500 | 150 | 150 | 80 |
| 2 | 00153008600 | 00153008500 | 150 | 300 | 80 |
| 3 | 00202008600 | 00202008500 | 200 | 200 | 80 |
| 4 | 00203008600 | 00203008500 | 200 | 300 | 80 |
| 5 | 00204008600 | 00204008500 | 200 | 400 | 80 |
| 6 | 00151512600 | 00151512500 | 150 | 150 | 120 |
| 7 | 00153012600 | 00153012500 | 150 | 300 | 120 |
| 8 | 00202012600 | 00202012500 | 200 | 200 | 120 |
| 9 | 00203012600 | 00203012500 | 200 | 300 | 120 |
| 10 | 00204012600 | 00204012500 | 200 | 400 | 120 |
| 11 | 00303012600 | 00303012500 | 300 | 300 | 120 |
| 12 | 00304012600 | 00304012500 | 300 | 400 | 120 |
| 13 | 00206012600 | 00206012500 | 200 | 500 | 120 |
| 14 | 00304015600 | 00304015500 | 300 | 400 | 155 |
| 15 | 00306015600 | 00306015500 | 300 | 600 | 155 |

*可定制非标产品 Nonstandard products can be customization

系列尺寸规格表

series dimensions table

| 规格尺寸 Dimensions | | | 宽度 Width | | | 高度 Height | | | 深度 Depth | | 安装板 Mounting plate | | |
|--------------------|-------------|------------|-------------|-----|-----|--------------|-----|-----|-------------|-----|-----------------------|------|-----|
| 宽 width | 高 height | 深 depth | B1 | B2 | B3 | H1 | H2 | H3 | T1 | T2 | F1 | F2 | G1 |
| 150 | 150 | 80 | 150 | 148 | 132 | 150 | 148 | 132 | 80 | 56 | 125 | 62.5 | 135 |
| 150 | 300 | 80 | 150 | 148 | 132 | 300 | 298 | 282 | 80 | 56 | 125 | 62.5 | 285 |
| 200 | 200 | 80 | 200 | 198 | 182 | 200 | 198 | 182 | 80 | 56 | 175 | 50 | 185 |
| 200 | 300 | 80 | 200 | 198 | 182 | 300 | 298 | 282 | 80 | 56 | 175 | 50 | 285 |
| 200 | 400 | 80 | 200 | 198 | 182 | 400 | 398 | 382 | 80 | 56 | 175 | 50 | 385 |
| 150 | 150 | 120 | 150 | 148 | 132 | 150 | 148 | 132 | 120 | 96 | 125 | 62.5 | 135 |
| 150 | 300 | 120 | 150 | 148 | 132 | 300 | 298 | 282 | 120 | 96 | 125 | 62.5 | 285 |
| 200 | 200 | 120 | 200 | 198 | 182 | 200 | 198 | 182 | 120 | 96 | 175 | 50 | 185 |
| 200 | 300 | 120 | 200 | 198 | 182 | 300 | 298 | 282 | 120 | 96 | 175 | 50 | 285 |
| 200 | 400 | 120 | 200 | 198 | 182 | 400 | 398 | 382 | 120 | 96 | 175 | 50 | 385 |
| 300 | 300 | 120 | 300 | 298 | 282 | 300 | 298 | 282 | 120 | 96 | 275 | 50 | 285 |
| 300 | 400 | 120 | 300 | 298 | 282 | 400 | 398 | 382 | 120 | 96 | 275 | 50 | 385 |
| 200 | 500 | 120 | 200 | 198 | 182 | 500 | 498 | 482 | 120 | 96 | 175 | 50 | 485 |
| 300 | 400 | 155 | 300 | 298 | 282 | 400 | 398 | 382 | 155 | 131 | 275 | 50 | 385 |
| 300 | 600 | 155 | 300 | 298 | 282 | 600 | 598 | 582 | 155 | 131 | 275 | 50 | 585 |

系列细节图

series detail drawing

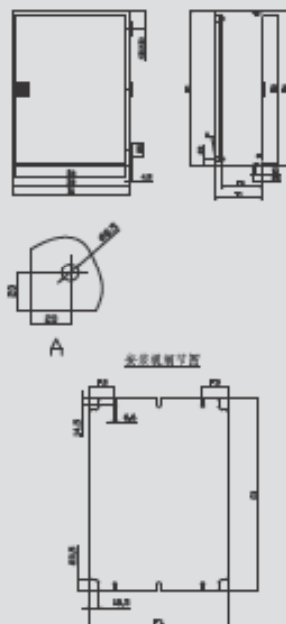

- 配置要求:
1. 在EB箱高度≥500时配
有两把小方锁;
2. 在EB箱高度≥600时配
有三把锁锁;
B1: 总宽度
B2: 门的宽度
B3: 箱体框架内的净宽
度
H1: 总高度
H2: 门的高度
H3: 箱体框架内的净高
度
T1: 总深度
T2: 安装板到门板的距
离
F1: 安装板的总宽度
F2: 安装板边缘固定孔
之间的距离
G1: 安装板的总高度
- Configuration requirements
1. The height of EB cabinet ≥500
Be provided with two small
square locks
2. The height of EB cabinet ≥600
Be provided with three
hinges
B1: Total width
B2: Door width
B3: Net width of the cabinet
inner frame
H1: Total height
H2: Door height
H3: Net height of the cabinet
bottom inner frame
T1: Total depth
T2: Distance from the mounting
plate to door plank
F1: Mounting plate width
F2: Distance from mounting plate
to the hole hole
G1: Mounting plate height

接线箱系列

Connection box series



| | |
|--------------------------------|---|
| 材料 Material | 冷轧钢板 Cold rolled steel sheet |
| 表面处理 Surface treatment | 箱体和门板氧化电泳处理, 外表面粉末涂层, 颜色可选RAL7032和RAL7035两种织纹 Each primer for box body and door plate; powder coating for outside; RAL7032 or RAL7035 texture optional |
| 防护等级 Protection grade | IP56级(GB4205-1993) IP56 (acc. to GB4205-1993) |
| 标准配置 Standard configuration | 门板、箱体、密封胶、箱盖螺钉、安装板(可选) Door plate, box body, sealing strip, cover screw, mounting plate (option) |
| 钢板厚度 Plate thickness | 箱体: 1.2-1.5mm 门板: 1.5mm 安装板: 2.5mm Box body: 1.2-1.5mm Door plate: 1.5mm Mounting plate: 2.5mm |



产品特点 Features of products

- 门板与箱体采用专用螺钉和护圈按通用标准安装，不但确保防护等级而且确保箱体在极狭小空间使用及维护
- 箱口多层保护槽不但能起加固作用而且能防止门板打开时脏物和水进入箱内
- PU发泡密封条确保箱体防护等级达到IP56
- 接地线可连接箱体和门板
- 箱体两侧配有开有螺丝孔的支架条，确保最大的安装高度，并可以安装支撑轨或安装板
- 特制的塑料绝缘套管不但能够密封而且能使门板螺丝不致脱落，并在螺丝拧紧时起导向的作用
- The door plate and box body are installed with special screws and retainers in accordance with common standards, which can ensure the Protection grade and the operation and maintenance in the narrow space in the box
- Multiple protection grooves are designed at the box opening can not only reinforce the structure but also prevent the entry of dirt or water when the door is opened
- PU foaming sealing strip ensures a protection grade of IP56 to box body
- The grounding can be connected to box body and door plate
- Racks with screw holes are provided on both sides of the box to ensure the max. mounting height and allow the installation of supporting rail or mounting plate
- The special plastic insulating sleeve can provide sealing and prevent door plate screw loosening, and guide screws when they are tightened

系列订货规格表

order specification table

*可定制非标产品
Nonstandard products are customizable

| 序号 No. | 订货号(KL) Order number (KL) | 订货号(KL) Order number(KL) | 宽 Width | 高 Height | 深 Depth |
|-----------|------------------------------|-----------------------------|------------|-------------|------------|
| 1 | 151508600 | 151508500 | 150 | 150 | 80 |
| 2 | 151512600 | 151512500 | 150 | 150 | 120 |
| 3 | 20150600 | 201508500 | 200 | 150 | 80 |
| 4 | 201512600 | 201512500 | 200 | 150 | 120 |
| 5 | 202012600 | 202012500 | 200 | 200 | 120 |
| 6 | 302012600 | 302012500 | 300 | 200 | 120 |
| 7 | 302015600 | 302015500 | 300 | 200 | 155 |
| 8 | 302021600 | 302021500 | 300 | 200 | 210 |
| 9 | 383021600 | 383021500 | 380 | 300 | 210 |
| 10 | 383821600 | 383821500 | 380 | 380 | 210 |

不锈钢接线箱系列

Stainless steel vertical control cabinet series



| | |
|--------------------------------|--|
| 材料 Material | SUS304(其它材料型号可选) SUS304 (other material types are optional) |
| 表面处理 Surface treatment | 拉丝, 安装板则为镀锌 Brushing, galvanized mounting plate |
| 防护等级 Protection grade | IP56(按GB4205-1993) IP56 (acc. to GB4205-1993) |
| 标准配置 Standard configuration | 门板、箱体、密封胶条、箱盖螺钉、安装板(可选) Door plate, box body, sealing strip, cover screw, mounting plate (optional) |
| 钢板厚度 Plate thickness | 箱体: 1.2-1.5mm 门板: 1.5mm 安装板: 2.5mm Box body: 1.2-1.5mm Door plate: 1.5mm Mounting plate: 2.5mm |



安装板(可选)
Mounting plate (optional)



壁挂件(SUS304)
Wall mounting parts (SUS304)



支撑轨
可支撑接线板和
输配电设备
Supporting rail
To support connection box
and power transmission/
distribution equipment

产品特点 Features of Products

- 门板与箱体采用专用螺钉和护圈按通用标准安装，不但确保防护等级而且确保箱体在极狭小空间使用及维护
- 箱口多层保护槽不但能起加固作用而且能防止门板打开时脏物和水进入箱内
- PU发泡密封条确保箱体防护等级达到IP56
- 接地线可连接箱体和门板
- 箱体两侧配有开有螺丝孔的支架条，确保最大的安装高度，并可以安装支撑轨或安装板
- 特制的塑料绝缘套管不但能够密封而且能使门板螺丝不致脱落，并在螺丝拧紧时起导向的作用
- 表面拉丝处理(高档箱体内部可做喷砂处理)
- The door plate and box body are installed with special screws and retainers in accordance with common standards, which can ensure the Protection grade and the operation and maintenance in the narrow space in the box
- Multiple protection grooves are designed at the box opening can not only reinforce the structure but also prevent the entry of dirt or water when the door is opened
- PU foaming sealing strip ensures a protection grade of IP56 to box body
- The ground can be connected to box body and door plate
- Racks with screw holes are provided on both sides of the box to ensure the max. mounting height and allow the installation of supporting rail or mounting plate
- The special plastic insulating sleeve can provide sealing and prevent door plate screw loosening, and guide screws when they are tightened
- Surface wire drawing treatment (sand blasting is available in high-class box)

系列订货规格表

order specification table

*可定制非标产品
Nonstandard products are customizable

| 序号 No. | 订货号(BKL) Order number (BKL) | 宽 Width | 高 Height | 深 Depth |
|-----------|--------------------------------|------------|-------------|------------|
| 1 | BKL151508304 | 150 | 150 | 80 |
| 2 | BKL151512304 | 150 | 150 | 120 |
| 3 | BKL201508304 | 200 | 150 | 80 |
| 4 | BKL201512304 | 200 | 150 | 120 |
| 5 | BKL202012304 | 200 | 200 | 120 |
| 6 | BKL302012304 | 300 | 200 | 120 |
| 7 | BKL302015304 | 300 | 200 | 155 |
| 8 | BKL302021304 | 300 | 200 | 210 |
| 9 | BKL383021304 | 380 | 300 | 210 |
| 10 | BKL383821304 | 380 | 380 | 210 |

* 细节图见15页 * See page 15 for BKL series detail drawing

安装板尺寸规格表

mounting plate dimensions table

| 安装板尺寸 Mounting plate dimensions | | | 箱体尺寸 Box dimensions | |
|---------------------------------|-----|----|---------------------|-----|
| G | F1 | F2 | 宽 | 高 |
| 135 | 125 | — | 150 | 150 |
| 185 | 125 | — | 200 | 150 |
| 185 | 175 | 50 | 200 | 200 |
| 285 | 175 | 50 | 300 | 200 |
| 285 | 275 | 50 | 300 | 300 |
| 385 | 275 | 50 | 380 | 300 |
| 385 | 365 | 50 | 380 | 380 |

尺寸规格表

dimensions table

| 规格尺寸 Dimensions | | | 宽度 Width | | | | | 高度 Height | | | | 深度 Depth |
|-----------------|-----|-----|----------|-----|-----|-----|-----|-----------|-----|-----|-----|----------|
| 总宽度 | 总高度 | 总深度 | B1 | B2 | B3 | B4 | B5 | H1 | H2 | H3 | H4 | T1 |
| 150 | 150 | 80 | 150 | 148 | 132 | 109 | 125 | 150 | 148 | 132 | 100 | 80 |
| 150 | 150 | 120 | 150 | 148 | 132 | 109 | 125 | 150 | 148 | 132 | 100 | 120 |
| 200 | 150 | 80 | 200 | 198 | 182 | 159 | 175 | 150 | 148 | 132 | 100 | 80 |
| 200 | 150 | 120 | 200 | 198 | 182 | 159 | 175 | 150 | 148 | 132 | 100 | 120 |
| 200 | 200 | 120 | 200 | 198 | 182 | 159 | 175 | 200 | 198 | 182 | 150 | 120 |
| 300 | 200 | 120 | 300 | 298 | 282 | 259 | 275 | 200 | 198 | 182 | 150 | 120 |
| 300 | 200 | 165 | 300 | 298 | 282 | 259 | 275 | 200 | 198 | 182 | 150 | 165 |
| 300 | 200 | 210 | 300 | 298 | 282 | 259 | 275 | 200 | 198 | 182 | 150 | 210 |
| 380 | 300 | 210 | 380 | 378 | 362 | 339 | 355 | 300 | 298 | 282 | 250 | 210 |
| 380 | 380 | 210 | 380 | 378 | 362 | 339 | 355 | 380 | 378 | 362 | 330 | 210 |

细节图

detail drawing

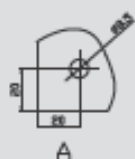
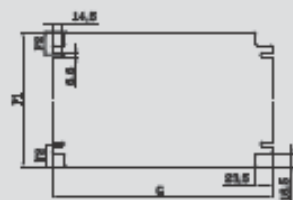
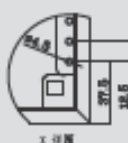
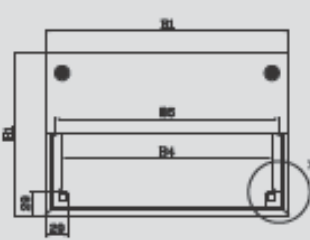

B1: 总宽度
B2: 箱盖的宽度
B3: 箱体框架内的净宽度
B4: 两根安装支架条之间的净宽度
B5: 框架内安装支架条之间的距离

H1: 总高度
H2: 箱盖的高度
H3: 箱体框架内的净高度
H4: 上下两浮动螺母之间的距离

T1: 总深度

B1: Total width
B2: Lid width
B3: Net width of the cabinet inner frame
B4: Net width between the two mounting brackets

B5: Distance between the two mounting brackets

H1: Total height

H2: Lid height

H3: Net width of the cabinet inner frame

H4: Distance between two up-down floating nuts

T1: Total depth

挂壁箱系列

wall mounted box series



| | |
|--------------------------------|---|
| 材料 Material | 冷轧钢板 Cold rolled steel sheet |
| 表面处理 Surface treatment | 箱体和门板氧化层处理，外覆为粉末涂层，颜色可分RAL7032和RAL7035两种颜色，安装板则为镀锌 Etch primer for box body and front door; powder coating for outside; RAL7032 or RAL7035 texture optional; galvanized mounting plate |
| 防护等级 Protection grade | IP56按GB4205-1993 IP56 (acc. to GB4205-1993) |
| 标准配置 Standard configuration | 门板、箱体、密封条、接地零件、安装板、门锁 Door plate, box body, sealing strip, grounding set, mounting plate, door lock |
| 钢板厚度 Plate thickness | 箱体: 1.5mm 门板: 2.0mm 安装板: 2.5mm Box body: 1.5mm Door plate: 2.0mm Mounting plate: 2.5mm |



防雨槽
防止雨水直接流入
Aweing
Prevent rainwater entering directly



门铰链
Door hinge



限位器
防止门打开后意外闭合，适用于户外、船舶等恶劣环境
Limiter
Prevent accidental closing of opened door, applicable for severe environments, e.g. outdoor, vessels

产品特点 Features of products

- PU发泡密封条确保箱体达到IP56的防护等级
- 各种类型及尺寸的凸台确保进出线方便
- 镀锌安装板也可在箱体外做布线用
- 箱口多层保护槽不但起加固作用而且能防止门板打开时脏物和水进入箱内
- 带双齿锁芯的专业锁系统开和关都极为便捷
- PU foaming sealing strip ensures a protection grade of IP56 to box body
- Bosses of various types and sizes allow easy installation of inlet/outlet lines
- Galvanized mounting plate can also be used for wiring outside the box
- Multiple protection grooves are designed at the box opening can not only reinforce the structure but also prevent the entry of dirt or water when the door is opened
- Professional lock system with double-teeth cylinder allows easy locking/unlocking

订货规格表 order specification table

*可定制非标产品
Nonstandard products are customizable

| 序号 No. | 订货号(AE) Order number (AE) | 订货号(AE) Order number (AE) | 宽 Width | 高 Height | 深 Depth |
|-----------|------------------------------|------------------------------|------------|-------------|------------|
| 1 | 203012600 | 203012500 | 200 | 300 | 120 |
| 2 | 203021600 | 203021500 | 200 | 300 | 210 |
| 3 | 304021600 | 304021500 | 300 | 400 | 210 |
| 4 | 383021600 | 383021500 | 380 | 300 | 210 |
| 5 | 383821600 | 383821500 | 380 | 380 | 210 |
| 6 | 405021600 | 405021500 | 400 | 500 | 210 |
| 7 | 386021600 | 386021500 | 380 | 600 | 210 |
| 8 | 505021600 | 505021500 | 500 | 500 | 210 |
| 9 | 606021600 | 606021500 | 600 | 600 | 210 |
| 10 | 607621600 | 607621500 | 600 | 760 | 210 |
| 11 | 607635600 | 607635500 | 600 | 760 | 350 |

*细节图见24页 * See page 24 for detail drawing

不锈钢挂壁箱系列

Stainless steel vertical control cabinet series



| | |
|--------------------------------|--|
| 材料 Material | SUS304(其它材料型号可选) SUS304 (other material types are optional) |
| 表面处理 Surface treatment | 拉丝, 安装板为镀锌 Wire drawing; galvanized mounting plate |
| 防护等级 Protection grade | IP56(按GB4205-1993) IP56 acc. to GB4205-1993 |
| 标准配置 Standard configuration | 门板、箱体、密封条、接地零件、安装板、门锁 Door plate, box body, sealing strip, grounding set, mounting plate, door lock |
| 钢板厚度 Plate thickness | 箱体: 1.5mm 门板: 2.0mm 安装板: 2.5mm Box body: 1.5mm Door plate: 2.0mm Mounting plate: 2.5mm |



壁挂件
Wall mounting parts



防水铆接螺栓
(可配合壁挂件使用)
Waterproof riveted bolt
(Can be used together with Wall mounting parts)



内部接地和110°
防水铰链
Internal grounding and
110° waterproof hinge

产品特点 Features of products

- PU发泡密封条确保箱体达到IP56的防护等级
- 镀锌安装板也可在箱体外做布线用
- 箱口多层保护槽不但起加固作用而且能防止门板打开时脏物和水进入箱内
- 专用的带双齿锁芯SUS304材质的不锈钢锁系统彰显档次，确保通用性
- 表面拉丝处理（高档箱体内部可做喷砂处理）
- PU foaming sealing strip ensures a protection grade of IP56 to box body
- Galvanized mounting plate can also be used for wiring outside the box
- Multiple protection grooves are designed at the box opening can not only reinforce the structure but also prevent the entry of dirt or water when the door is opened
- Special SUS304 stainless steel lock system with double-teeth cylinder shows high quality and ensures universality
- Surface wire drawing treatment (sand blasting is available in high-class box)

订货规格表

order specification table

| 序号 No. | 订货号(BAE) Order number (BAE) | 宽 Width | 高 Height | 深 Depth |
|-----------|--------------------------------|------------|-------------|------------|
| 1 | 203012304 | 200 | 300 | 120 |
| 2 | 203021304 | 200 | 300 | 210 |
| 3 | 304021304 | 300 | 400 | 210 |
| 4 | 383021304 | 380 | 300 | 210 |
| 5 | 383821304 | 380 | 380 | 210 |
| 6 | 405021304 | 400 | 500 | 210 |
| 7 | 386021304 | 380 | 600 | 210 |
| 8 | 505021304 | 500 | 500 | 210 |
| 9 | 606021304 | 600 | 600 | 210 |
| 10 | 607621304 | 600 | 760 | 210 |
| 11 | 607635304 | 600 | 760 | 350 |

*细节图见24页

*See page 24 for series detail drawing

立式控制箱系列

vertical control box series



| | |
|--------------------------------|---|
| 材料 Material | 冷轧钢板 Cold rolled steel sheet |
| 表面处理 Surface treatment | 箱体和门板磷化底涂处理，外部为粉末涂层，颜色可分RAL 7032和RAL 7035两种款式，安装板则为镀锌板 Etch primer for box body and door plate; powder coating for outside; RAL 7032 or RAL 7035 texture optional; galvanized mounting plate |
| 防护等级 Protection grade | IP56 (按GB4205-1983) IP56 (acc. to GB4205-1993) |
| 标准配置 Standard configuration | 门板、箱体、密封条、接地零件、安装板、门钩(带锁钩) Door plate, box body, sealing strip, grounding set, mounting plate, door lock (turnoff lock) |
| 钢板厚度 Plate thickness | 箱体: 1.5mm 门板: 2.0mm 安装板: 2.5mm Box body: 1.5mm Door plate: 2.0mm Mounting plate: 2.5mm |



接地线
Grounding wire



进出线凸台
Inlet/outlet line base



分道锁
Turnoff lock

产品特点 Features of products

- PU发泡密封条确保箱体达到IP56的防护等级
- 各种类型及尺寸的凸台确保进出线方便
- 镀锌安装板也可在箱体外做布线用
- 箱口多层保护槽不但起加固作用而且能防止门板打开时脏物和水进入箱内
- 带双齿锁芯的岔道锁系统开和关不但极为便捷，而且确保了其通用性
- 两侧带折边的安装板和安装支架最大限度的确保了安装强度
- PU foaming sealing strip ensures a protection grade of IP56 to box body
- Bosses of various types and sizes allow easy installation of inlet/outlet lines
- Galvanized mounting plate can also be used for wiring outside the box
- Multiple protection grooves are designed at the box opening can not only reinforce the structure but also prevent the entry of dirt or water when the door is opened
- Professional turnoff lock system with double-teeth cylinder allows easy locking/unlocking and universality
- Mounting plate and supporting rack with flanges on both sides ensures the max. mounting strength

订货规格表

Specifications

*可定制非标产品
Nonstandard products are customizable

| 序号 No. | 订货号(AE) Order number (AE) | 订货号(AE) Order number (AE) | 宽 Width | 高 Height | 深 Depth |
|-----------|------------------------------|------------------------------|------------|-------------|------------|
| 1 | 608025600 | 608025500 | 600 | 800 | 250 |
| 2 | 609030600 | 609030500 | 600 | 900 | 300 |
| 3 | 801030600 | 801030500 | 800 | 1000 | 300 |
| 4 | 601230600 | 601230500 | 600 | 1200 | 300 |

* 细节图见24页 * See page 24 for detail drawing

不锈钢立式控制箱系列

Stainless steel vertical control box series



| | |
|-----------------------------------|--|
| 材料 Material | SUS304 (其它材料型号可选) SUS304 (other material types are optional) |
| 表面处理 Surface treatment | 拉丝, 安装板洞为镀锌 Wire drawing; galvanized mounting plate |
| 防护等级 Protection grade | IP56 (按 GB4205-1993) IP56 (acc. to GB4205-1993) |
| 标准配置 Standard configuration | 门板、箱体、密封条、接地零件、安装板、门锁 Door plate, box body, sealing strip, grounding set, mounting plate, door lock |
| 钢板厚度 Plate thickness | 箱体: 1.5mm 门板: 2.0mm 安装板: 2.5mm Box body: 1.5mm Door plate: 2.0mm Mounting plate: 2.5mm |



壁挂件
Wall mounting parts



防雨顶罩
Rain hood



不锈钢锁 (可选不锈钢无钥匙系统)
Stainless steel lock (optional
stainless steel turnoff lock system
optional)

产品特点 Features of products

- PU发泡密封条确保箱体达到IP56的防护等级
- 镀锌安装板也可在箱体外做布线用
- 箱口多层保护槽不但起加固作用而且能防止门板打开时脏物和水进入箱内
- 专用的带双齿锁芯SUS304材质的不锈钢锁系统彰显档次，确保通用性
- 表面拉丝处理(高档箱体内部可做喷砂处理)
- 带折边的安装板和安装板支架最大限度的确保安装强度
- PU foaming sealing strip ensures a protection grade of IP56 to box body
- Galvanized mounting plate can also be used for wiring outside the box
- Multiple protection grooves are designed at the box opening can not only reinforce the structure but also prevent the entry of dirt or water when the door is opened
- Special SUS304 stainless steel lock system with double-teeth cylinder shows high quality and ensures universality
- Surface wire drawing treatment (sand blasting is available in high-class box)
- Mounting plate and supporting rack with flanges ensures the max. mounting strength

系列订货规格表

order specification table

*可定制非标产品
Nonstandard products are customizable

| 序号 No. | 订货号(BAE) Order number (BAE) | 宽 Width | 高 Height | 深 Depth |
|-----------|--------------------------------|------------|-------------|------------|
| 1 | 608025304 | 600 | 800 | 250 |
| 2 | 609030304 | 600 | 900 | 300 |
| 3 | 801030304 | 800 | 1000 | 300 |
| 4 | 601230304 | 600 | 1200 | 300 |

*细节图见24页

*See page 24 for detail drawing

尺寸规格表

Series dimensions table

| 规格尺寸 Dimensions | | | 宽度 Width | | | | | 高度 Height | | | 深度 Depth | | | 安装板 Mounting plate | |
|--------------------|-------------------|--|-------------|-----|-----|-----|-----|--------------|------|------|-------------|-----|-----|-----------------------|------|
| 总宽度 Total width | 门宽度 Door width | 箱体净宽 Net width of cabinet inner frame | B1 | B2 | B3 | B4 | B5 | H1 | H2 | H3 | T1 | T2 | T3 | F | G |
| 200 | 300 | 120 | 200 | 197 | 162 | 111 | 123 | 300 | 295 | 260 | 120 | 100 | 94 | 150 | 250 |
| 200 | 300 | 210 | 200 | 197 | 162 | 111 | 123 | 300 | 295 | 260 | 210 | 190 | 184 | 150 | 250 |
| 300 | 400 | 210 | 300 | 297 | 262 | 211 | 223 | 400 | 395 | 360 | 210 | 190 | 184 | 250 | 350 |
| 380 | 300 | 210 | 380 | 377 | 342 | 291 | 303 | 300 | 295 | 260 | 210 | 190 | 184 | 330 | 250 |
| 380 | 380 | 210 | 380 | 377 | 342 | 291 | 303 | 380 | 375 | 340 | 210 | 190 | 184 | 330 | 330 |
| 400 | 500 | 210 | 400 | 397 | 362 | 311 | 323 | 500 | 495 | 460 | 210 | 190 | 184 | 360 | 450 |
| 380 | 800 | 210 | 380 | 377 | 342 | 291 | 303 | 600 | 595 | 560 | 210 | 190 | 184 | 330 | 550 |
| 500 | 500 | 210 | 500 | 497 | 462 | 411 | 423 | 500 | 495 | 460 | 210 | 190 | 184 | 460 | 450 |
| 600 | 600 | 210 | 600 | 597 | 562 | 511 | 523 | 600 | 595 | 560 | 210 | 190 | 184 | 550 | 550 |
| 600 | 760 | 210 | 600 | 597 | 562 | 511 | 523 | 760 | 755 | 720 | 210 | 190 | 184 | 550 | 710 |
| 600 | 760 | 350 | 600 | 597 | 562 | 511 | 523 | 760 | 755 | 720 | 350 | 330 | 324 | 550 | 710 |
| 600 | 800 | 250 | 600 | 597 | 562 | 511 | 523 | 800 | 795 | 760 | 250 | 230 | 224 | 540 | 754 |
| 600 | 900 | 300 | 600 | 597 | 562 | 511 | 523 | 900 | 895 | 860 | 300 | 280 | 274 | 540 | 854 |
| 800 | 1000 | 300 | 800 | 797 | 762 | 711 | 723 | 1000 | 995 | 960 | 300 | 280 | 274 | 740 | 954 |
| 800 | 1200 | 300 | 800 | 597 | 562 | 511 | 523 | 1200 | 1195 | 1160 | 300 | 280 | 274 | 540 | 1154 |

细节图

Series detail drawing

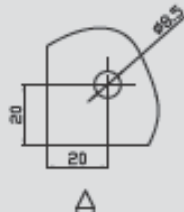
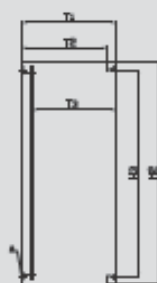
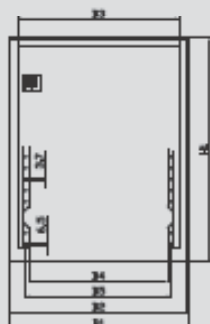

配置要求:

1. 在AE箱高度<500时配有一把小方锁
2. 在760>AE箱高度≥500时配有两把小方锁
3. 在AE箱高度≥760时配有一把芯锁
4. AE箱高度>760时配有带折弯的安装板

Configuration requirements

1. The height of AE cabinet<500 Be provided with a small square lock
2. 760>The height of AE cabinet≥500 Be provided with two small square locks
3. The height of AE cabinet≥700 Be provided with a fork lock
4. The height of AE cabinet>760 Be provided with bending-edge mounting plate.

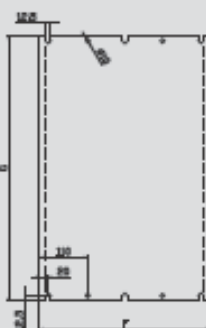
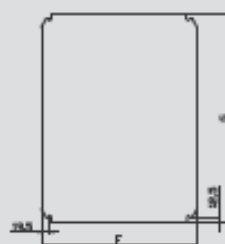

- B1: 总宽度
- B2: 门的宽度
- B3: 箱体框架内的净宽度
- B4: 箱门管状框架内的净宽度
- B5: 箱门把手两侧或排穿孔嵌条之间的距离

- H1: 总高度
- H2: 门的高度
- H3: 箱体框架内的净高度

- T1: 总深度
- T2: 箱体深度
- T3: 安装板到门板的距离

- F: 安装板的总宽度
- G: 安装板的总高度

- B1: Total width
- B2: Door width
- B3: Net width of the cabinet inner frame
- B4: Net width of the cabinet door inner tubular-shape frame
- B5: Distance between two sides of perforated panel strip rows of the door frame,

- H1: Total height
- H2: Door height
- H3: Net height of the cabinet bottom inner frame

- T1: Total depth
- T2: Cabinet cabinet depth
- T3: Distance from the mounting plate to the door

- F: Mounting plate width
- G: Mounting plate height

豪华立式控制箱系列

luxury vertical control box series



| | |
|--------------------------------|---|
| 材料 Material | 冷轧钢板 Cold rolled steel sheet |
| 表面处理 Surface treatment | 箱体和门板磷化电泳处理, 外部为粉末涂漆, 可选RAL 7032 或RAL 7035两种颜色。安装板则为镀锌 Etch primer for box body and door plate; powder coating for outside; RAL 7032 or RAL 7035 texture optional; galvanized mounting plate |
| 防护等级 Protection grade | IP56(按GB4205-1993) IP56 (acc. to GB4205-1993) |
| 标准配置 Standard configuration | 门板、箱体、密封胶、接地零件、安装板、门锁、运输吊环(可选) Door plate, box body, sealing strip, grounding set, mounting plate, door lock, lifting ring (optional) |
| 钢板厚度 Plate thickness | 箱体: 1.5, 2.0 (可选) 门板: 2.0mm 安装板: 标配2.5mm Door plate: 1.5mm Door plate: 2.0mm Mounting plate: standard 2.5mm |



坚固的门板方管加强筋
Firm door plate square tube stiffener



加强的多折箱体边框
灵活的底部进出线方式
Reinforced folded box frame; flexible bottom inlet/outlet line mode



锌合金130° 承重铰链
高强度的安装板支架
Zinc alloy 130° bearing hinge
High strength mounting plate rack

产品特点 Features of products

- PU发泡的密封条确保箱体达到IP56的防护等级
- 加宽的箱体边框、承重铰链、门板方管加强筋确保箱体系统的高强度
- 镀锌安装板和高强度的安装板支架确保安装器件的可靠性(可在箱外做布线)
- 底部进出线装置确保进出线的灵活方便
- 可选的运输吊环系统确保运输的方便快捷
- PU foaming sealing strip ensures a protection grade of IP56 to box body
- Widened box frame, bearing hinge and door plate square tube stiffener ensures high strength of the box body
- The mounting plate and high-strength mounting rack ensures the reliability of the mounting parts (can be used for wiring outside the box)
- Bottom inlet/outlet line device allows easy installation of inlet/outlet lines
- Optional lifting ring system allows easy handling

订货规格表

order specification table

*可定制非标产品
Nonstandard products are customizable

| 序号 No. | 订货号(AK) Order number (AK) | 订货号(AK) Order number (AK) | 宽 Width | 高 Height | 深 Depth |
|-----------|------------------------------|------------------------------|------------|-------------|------------|
| 1 | 801230600 | 801230500 | 800 | 1200 | 300 |
| 2 | 101030600 | 101030500 | 1000 | 1000 | 300 |
| 3 | 101230600 | 101230500 | 1000 | 1200 | 300 |
| 4 | 601240600 | 601240500 | 600 | 1200 | 400 |
| 5 | 801240600 | 801240500 | 800 | 1200 | 400 |
| 6 | 121240600 | 121240500 | 1200 | 1200 | 400 |

*细节图见28页

*See page 28 for Detail

不锈钢豪华立式控制箱系列

Stainless steel luxury vertical control box series

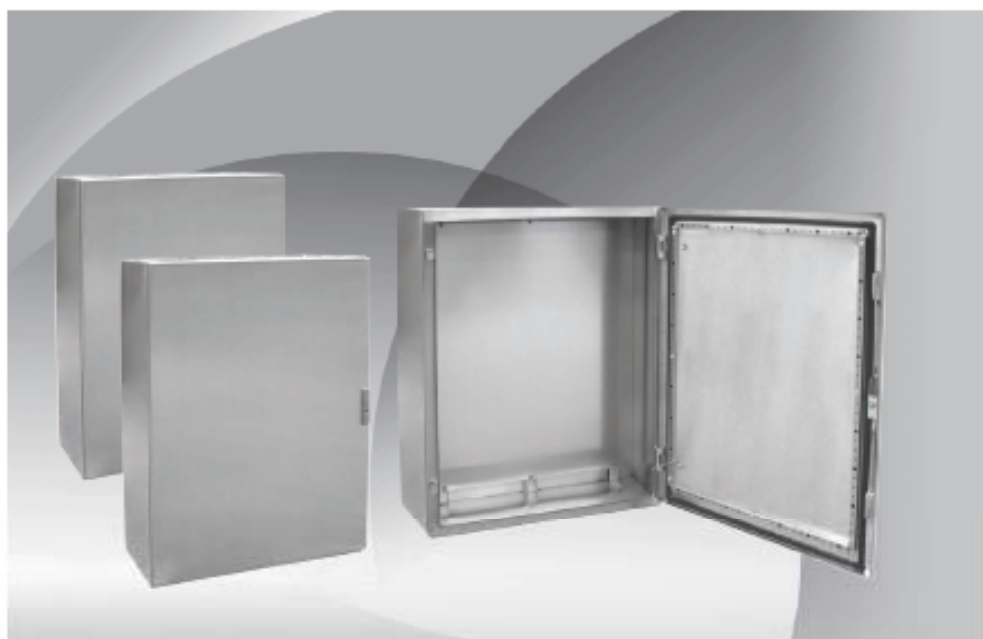

| | |
|--------------------------------|--|
| 材料 Material | SUS304 (其它材料型号可选) SUS304 (other material types are option) |
| 表面处理 Surface treatment | 拉丝, 安装板则为镀锌 Wire drawing/galvanized mounting plate |
| 防护等级 Protection grade | IP54(按GB4205-1993) IP56(按GB4205-1993) |
| 标准配置 Standard configuration | 门板, 箱体, 密封条, 接地零件, 安装板, 门锁 Door plate, box body, sealing strip, grounding set, mounting plate, door lock |
| 钢板厚度 Plate thickness | 箱体: 1.5, 2.0(可选) 门板: 2.0mm 安装板: 2.5mm Box body: 1.5mm Door plate: 2.0mm Mounting plate: 2.5mm |



不锈钢平面锁
Stainless steel flat lock



坚固的门板方管加强筋
Firm door plate square tube stiffener



锌合金130度承重铰链
Zinc alloy 130° bearing hinge

产品特点 Features of products

- PU发泡的密封条确保箱体达到IP56的防护等级
- 加宽的箱体边框、承重铰链、门板方管加强筋确保箱体系统的高强度
- 可选3.0mm的镀锌安装板和高强度的安装板支架确保安装器件的可靠性（可在箱外做布线用）
- 底部进出线装置确保进出线的灵活方便
- 可选的不锈钢运输吊环系统确保运输的方便快捷
- 表面拉丝处理（高档箱体内部可做喷砂处理）
- PU foaming sealing strip ensures a protection grade of IP56 to box body
- Widened box frame, bearing hinge and door plate square tube stiffener ensures high strength of the box body
- The Optional 3.0 mm galvanized plate and the high strength mounting plate bracket ensure the reliability of the installation device (can use for wiring outside the cabinet).
- The Outlet and inlet wires of the device at the bottom ensure the flexible and convenient of the outlet and inlet wire.
- The optional stainless steel transportation flying rings system ensures fast and convenience of the transportation.
- The surface wire drawbench processing (the sandblasting processing can be available in the high-grade cabinets)

订货规格表

order specification table

*可定制非标产品
Nonstandard products are customizable

| 序号No. | 订货号(BAK) Order number (BAK) | 宽Width | 高Height | 深Depth |
|-------|--------------------------------|--------|---------|--------|
| 1 | BAK801230304 | 800 | 1200 | 300 |
| 2 | BAK101030304 | 1000 | 1000 | 300 |
| 3 | BAK101230304 | 1000 | 1200 | 300 |
| 4 | BAK801240304 | 600 | 1200 | 400 |
| 5 | BAK801240304 | 800 | 1200 | 400 |
| 6 | BAK121240304 | 1200 | 1200 | 400 |

尺寸规格表

dimensions table

| 规格尺寸Dimensions | | | 宽Width | | | | | | 高Height | | 深Depth | | 安装板 Mounting plate | |
|----------------|------|-----|--------|-------|------|---------|-----|-----|---------|------|--------|-----|-----------------------|------|
| 宽 | 高 | 深 | B1 | B2 | B3 | B4 | B5 | B6 | H1 | H2 | T1 | T2 | F | G |
| 800 | 1200 | 300 | 800 | 600 | 710 | 792 | 674 | 654 | 1200 | 1175 | 300 | 275 | 700 | 1100 |
| 1000 | 1000 | 300 | 1000 | 800 | 910 | 992 | 874 | 854 | 1000 | 975 | 300 | 275 | 900 | 900 |
| 1000 | 1200 | 300 | 1000 | 800 | 910 | 992 | 874 | 854 | 1200 | 1175 | 300 | 275 | 900 | 1100 |
| 600 | 1200 | 400 | 600 | 400 | 510 | 592 | 474 | 454 | 1200 | 1175 | 400 | 375 | 500 | 1100 |
| 800 | 1200 | 400 | 800 | 600 | 710 | 792 | 674 | 654 | 1200 | 1175 | 400 | 375 | 700 | 1100 |
| 1200 | 1200 | 400 | 1200 | 400*2 | 1110 | 593.5*2 | 474 | 454 | 1200 | 1175 | 400 | 375 | 1100 | 1100 |

细节图

detail drawing

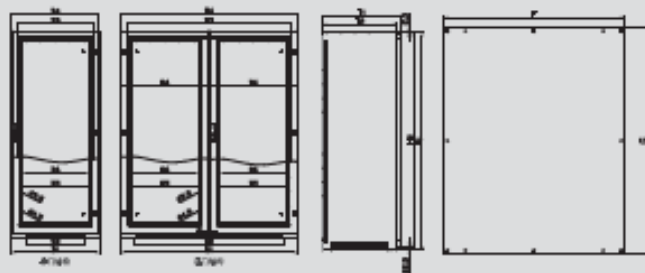

B1: 总宽度
B2: 实际总安装宽度(宽度<1000, 实际总安装板分左
右2部分)

B3: 箱体内部内档净宽度

B4: 门板宽度

B5: 门板后部方管加强筋距安装中心尺寸

B6: 门板前部方管加强筋距门板尺寸

H1: 柜体高度

H2: 门板高度

T1: 柜体总深度

T2: 柜体不含门板深度

F: 安装板宽度

G: 安装板高度

B1: Total width

B2: Wiring insert width of the bottom plate (cabinet width ≥ 1200 , wiring insert plate in the bottom divide into left and right 2 parts)

B3: Net width of the cabinet framework

B4: Door plate width

B5: The center size of the square tube reinforcing rib installation in the back of door plate

B6: The interior size of the square tube reinforcing rib in the back of door plate

H1: Cabinet height

H2: Door plate height

T1: Cabinet total depth

T2: cabinet depth without door plate

F: Mounting plate width

G: Mounting plate height

*B1: 宽度 ≥ 1100 的2.5镀锌安装板在中间共加固定方式。

*B1: 2.5 galvanized mounting plate with width ≥ 1100 is additionally fixed at the center.

铸铝接线盒

Connection box series

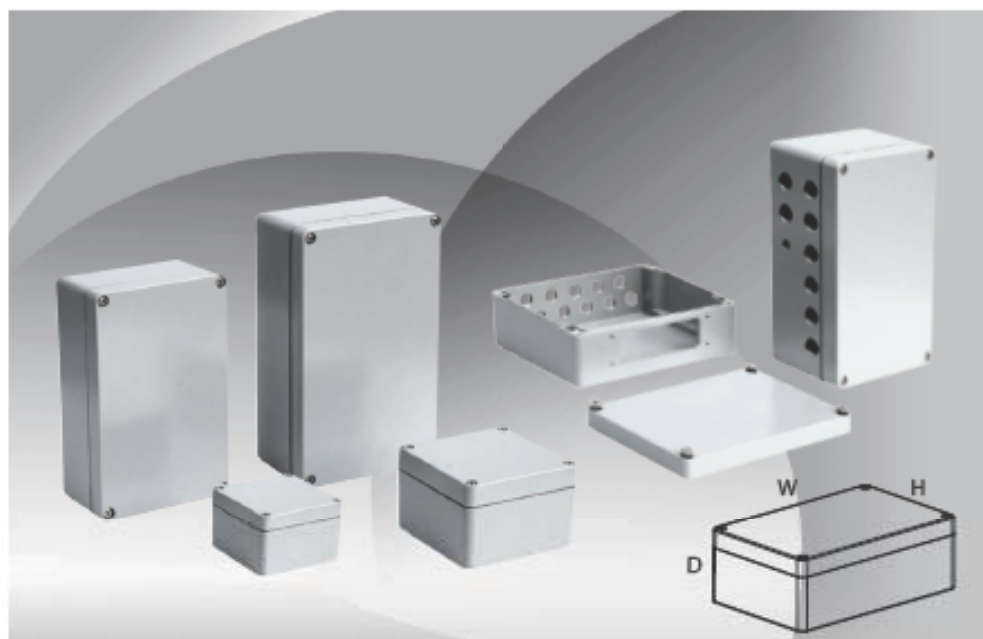

| | |
|---|--|
| 材料 Material | 压铸铝合金A512 Pack alloy A512 |
| 密封胶 Sealing strip | 硅橡胶(可提供特制密封胶) Silicon rubber (special sealing strip option) |
| 防护等级 Protection grade | IP66(可提供认证) IP 66 (certification option) |
| 使用环境温度 Operating environment temperature | -50℃至+130℃ -50℃ to +130℃ |
| 盖盖螺钉 Cover screw | 不锈钢十字槽(不易脱落) Stainless steel cross slot (loose-proof) |
| 颜色 Color | 近白(RAL7001) (可提供特殊色) Near RAL7001 (special color available) |
| 加工服务 Processing service | 可按客户要求加工, 并安装电缆接头和接线端子等附件。 Processing as customer requested available with cable connectors and terminals installed |

订货规格表

order specification table

单位: mm
Unit: mm

| 订货号(LH) Order number (LH) | 宽Width(W) | 高Height(H) | 深Depth(D) | 卡轨长度 Rail length(LH) |
|------------------------------|-----------|------------|-----------|-------------------------|
| 111 | 64 | 58 | 36 | ---- |
| 121 | 98 | 64 | 36 | ---- |
| 131 | 125 | 80 | 57 | 115 (TS15) |
| 141 | 75 | 80 | 57 | 64 (TS15) |
| 171 | 250 | 80 | 57 | 240 (TS15) |
| 211 | 122 | 120 | 80 | 109 (TS15) |
| 221 | 160 | 160 | 90 | 147 (TS15) |
| 231 | 220 | 140 | 80 | 207 (TS15) |
| 241 | 220 | 122 | 90 | 207 (TS15) |
| 251 | 200 | 230 | 110 | 185 (TS15) |
| 261 | 260 | 160 | 90 | 245 (TS15) |
| 271 | 320 | 160 | 90 | 306 (TS15) |
| 281 | 280 | 230 | 110 | 265 (TS15) |
| 331 | 330 | 230 | 110 | 315 (TS15) |
| 401 | 402.5 | 310 | 110 | 385 (TS15) |



机柜系列 Cabinet series

独立式控制柜系列

Stand-alone control cabinet series



| | |
|--------------------------------|--|
| 材料 Material | 冷轧钢板 Cold rolled steel sheet |
| 表面处理 Surface treatment | 有机磷化涂层处理，外部为粉末涂层，颜色可分RAL7032和RAL7035两种颜色。安装板可为镀锌。 Each primer for cabinet; powder coating for outside; RAL7032 or RAL7035 texture optional; galvanized mounting plate |
| 防护等级 Protection grade | IP55(按GB4205-1993) IP65(acc. to GB4205-1993) |
| 标准配置 Standard configuration | 前门、背板、安装板、柜体、门锁、密封条 Front door, back plate, mounting plate, cabinet, door lock, sealing strip |
| 钢板厚度 Plate thickness | 柜体：五折型材1.5mm 门板：2.0mm 背板：1.5mm 安装板：2.5mm Frame: 5-fold section 1.5mm Door plate: 2.0mm Back plate: 1.5mm Mounting plate: 2.5mm |

五折结构框架
5-fold structural frame加强方管与A3资料盒
Reinforcing square tube and A3 document box三段活动进出线装置
Three-section flexible inlet/outlet line device

产品特点 Features of product

- 独立式电柜，不适宜并柜使用
- 门板离地面高，约25mm，确保开门灵活顺畅
- 独特的五折型材整体焊接而成的主体框架不但确保柜体的高强度而且使柜体的防护等级达到IP55
- 特殊的门板方管加强系统可以用螺丝固定在门板上，便于拆卸
- 框架上密布的25mm 间距模数孔确保安装的灵活性、通用性
- 镀锌安装板可以利用塑料滑块通过导轨从正面推入柜内，且两边有U型折边使安装板更牢固和更便于搬运
- Stand-alone electric cabinet, inapplicable for cabinet incorporation
- Ground clearance of door plate is sufficient, about 25mm, ensuring flexibility and smoothness of door opening.
- IP55 Unique main body frame integrally welded with 5-fold sections ensures high strength and IP55 of cabinet body
- Special door plate square tube reinforcing system can be fixed on door plate by screws for easy disassembly
- Modular holes with a spacing of 25mm on the frame ensures flexibility and universality of installation
- The mounting plate can be pushed into the cabinet by plastic slide through rail; U flanges on both sides allow firmer mounting plate and easier handling

订货规格表

order specification table

*可定制非标产品
Nonstandard products are customizable

| 序号 No. | 订货号 Order number | 订货号 Order number | 宽 Width | 高 Height | 深 Depth |
|-----------|---------------------|---------------------|------------|-------------|------------|
| 1 | 601640600 | 601640500 | 600 | 1600 | 400 |
| 2 | 601650600 | 601650500 | 600 | 1600 | 500 |
| 3 | 601840600 | 601840500 | 600 | 1800 | 400 |
| 4 | 601850600 | 601850500 | 600 | 1800 | 500 |
| 5 | 602050600 | 602050500 | 600 | 2000 | 500 |
| 6 | 801650600 | 801650500 | 800 | 1600 | 500 |
| 7 | 801840600 | 801840500 | 800 | 1800 | 400 |
| 8 | 801850600 | 801850500 | 800 | 1800 | 500 |
| 9 | 802050600 | 802050500 | 800 | 2000 | 500 |
| 10 | 802060600 | 802060500 | 800 | 2000 | 600 |
| 11 | 101840600 | 101840500 | 1000 | 1800 | 400 |
| 12 | 121650600 | 121650500 | 1200 | 1600 | 500 |
| 13 | 121840600 | 121840500 | 1200 | 1800 | 400 |
| 14 | 122050600 | 122050500 | 1200 | 2000 | 500 |

*ES系列节图见37页
*See Page 37 for Detail Drawing

独立式控制柜系列

Independent control cabinet series



| | |
|--------------------------------|---|
| 材料 Material | SUS304 (其它材料型号可选) SUS304 (other material types are optional) |
| 表面处理 Surface treatment | 拉丝, 安装板即为镀锌 Wire drawing, and mounting plate is galvanized |
| 防护等级 Protection grade | IP55 (按 GB4208-1993) IP55 (in the light of GB4208-1993) |
| 标准配置 Standard configuration | 前门、背板、安装板、 柜体、门锁、密封条 Front door, back plate, mounting plate, cabinet body, door lock and sealing strip |
| 钢板厚度 Plate thickness | 框架: 五折型材 1.5mm 门板: 2.0mm 背板: 1.5mm 安装板: 2.5mm Frame: five-fold section 1.5mm Door plate: 2.0mm Back plate: 1.5mm Mounting plate: 2.5mm |



不锈钢承重吊环
Stainless steel bearing suspension loop



不锈钢平盖锁
Stainless steel flat lock



密封条/高强度方管
Sealing strip/high strength square pipe



限位器
Stopper



不锈钢A3文件夹
Stainless steel A3 folder



铁耳吊架
Long iron with suspension loop

产品特点 Features of product

- 独立式电柜，不适宜并柜使用
- 门板离地面高，约25mm，确保开门灵活顺畅
- 独特的五折型材整体焊接而成的主体框架不但确保柜体的高强度而且确保柜体的防护等级达到IP66
- 特殊的门板方管加强系统可以用螺丝固定在门板上，便于拆卸
- 框架上密布的25mm 间距模数孔确保安装的灵活性、通用性
- 镀锌安装板可以利用塑料滑块通过导轨从正面推入柜内，且两边有U型折边使安装板更牢固和更便于搬运
- 专业的不锈钢防盗锁、不锈钢承重吊环以及各种功能性的附件彰显柜体豪华品质
- Stand-alone electric cabinet, unsuitable for combination
- Ground clearance of door plate is sufficient, about 25mm, ensuring flexibility and smoothness of door opening.
- IP66The main body frame specially fabricated by five-fold section through whole welding ensures not only high strength but also the Protection grade of IP66.
- Special door plate square pipe reinforcement system can be fixed on the door plate with screws, easy for dismantlement.
- Module holes densely distributed at 25mm spacing on the frame guarantee flexibility and universality of installation
- The mounting plate can be pushed into the cabinet from the front through guide rail by making use of plastic sliders. U-shape folded edges at the two sides facilitate fastening and handling of the mounting plate.
- Professional stainless steel turnoff lock, stainless steel bearing suspension loops and other accessories having various functions bring out luxury character of cabinet body.

订货规格表

order specification table

*可定制非标产品
Nonstandard products are customizable

| 序号No. | 订货号 Order number | 宽 Width | 高 Height | 深 Depth |
|-------|---------------------|---------|----------|---------|
| 1 | S601640304 | 600 | 1600 | 400 |
| 2 | S601650304 | 600 | 1600 | 500 |
| 3 | 601840304 | 600 | 1800 | 400 |
| 4 | 601850304 | 600 | 1800 | 500 |
| 5 | 602050304 | 600 | 2000 | 500 |
| 6 | 801650304 | 800 | 1600 | 500 |
| 7 | 801840304 | 800 | 1800 | 400 |
| 8 | 801850304 | 800 | 1800 | 500 |
| 9 | 802050304 | 800 | 2000 | 500 |
| 10 | 802060304 | 800 | 2000 | 600 |
| 11 | 101840304 | 1000 | 1800 | 400 |
| 12 | 121650304 | 1200 | 1600 | 500 |
| 13 | 121840304 | 1200 | 1800 | 400 |
| 14 | 122050304 | 1200 | 2000 | 500 |

*请参见37页
*See Page 37 for Detail Drawing

尺寸规格表
 dimension table

| 规格尺寸 Dimension | | | 宽度 Width | | | | | | | 高度 Height | | | | | | | 深度 Depth | | | | | | 安装板 Mounting plate | | | |
|-------------------|------|-----|-------------|---------|------|------|-------|-------|------|--------------|------|------|------|------|------|------|-------------|-----|-----|-----|-----|-----|-----------------------|-----|------|------|
| 宽 | 高 | 深 | B1 | B2 | B3 | B5 | B6 | B7 | B8 | B9 | H1 | H2 | H3 | H5 | H6 | H7 | H8 | H9 | T1 | T2 | T3 | T4 | T5 | T6 | F | G |
| 600 | 1600 | 400 | 600 | 592 | 510 | 470 | 454 | 474 | 535 | 400 | 1600 | 1575 | 1512 | 1535 | 1450 | 1430 | 1400 | 795 | 400 | 265 | 200 | 350 | 325 | 349 | 498 | 1496 |
| 600 | 1600 | 500 | 600 | 592 | 510 | 470 | 453 | 474 | 535 | 400 | 1600 | 1575 | 1512 | 1535 | 1450 | 1430 | 1400 | 795 | 500 | 365 | 300 | 450 | 425 | 449 | 498 | 1496 |
| 600 | 1800 | 400 | 600 | 592 | 510 | 470 | 453 | 474 | 535 | 400 | 1800 | 1775 | 1712 | 1735 | 1650 | 1630 | 1600 | 895 | 400 | 265 | 200 | 350 | 325 | 349 | 498 | 1696 |
| 600 | 1800 | 500 | 600 | 592 | 510 | 470 | 453 | 474 | 535 | 400 | 1800 | 1775 | 1712 | 1735 | 1650 | 1630 | 1600 | 895 | 500 | 365 | 300 | 450 | 425 | 449 | 498 | 1696 |
| 600 | 2000 | 500 | 600 | 592 | 510 | 470 | 453 | 474 | 535 | 400 | 2000 | 1975 | 1912 | 1935 | 1850 | 1830 | 1800 | 995 | 500 | 365 | 300 | 450 | 425 | 449 | 498 | 1896 |
| 800 | 1600 | 500 | 800 | 792 | 710 | 670 | 653 | 674 | 735 | 600 | 1600 | 1575 | 1512 | 1535 | 1450 | 1430 | 1400 | 795 | 500 | 365 | 300 | 450 | 425 | 449 | 698 | 1496 |
| 800 | 1800 | 400 | 800 | 792 | 710 | 670 | 653 | 674 | 735 | 600 | 1800 | 1775 | 1712 | 1735 | 1650 | 1630 | 1600 | 895 | 400 | 265 | 200 | 350 | 325 | 349 | 698 | 1696 |
| 800 | 1800 | 500 | 800 | 792 | 710 | 670 | 653 | 674 | 735 | 600 | 1800 | 1775 | 1712 | 1735 | 1650 | 1630 | 1600 | 895 | 500 | 365 | 300 | 450 | 425 | 449 | 698 | 1696 |
| 800 | 2000 | 500 | 800 | 792 | 710 | 670 | 653 | 674 | 735 | 600 | 2000 | 1975 | 1912 | 1935 | 1850 | 1830 | 1800 | 995 | 500 | 365 | 300 | 450 | 425 | 449 | 698 | 1896 |
| 800 | 2000 | 600 | 800 | 792 | 710 | 670 | 653 | 674 | 735 | 600 | 2000 | 1975 | 1912 | 1935 | 1850 | 1830 | 1800 | 995 | 600 | 465 | 400 | 550 | 525 | 549 | 698 | 1896 |
| 1000 | 1800 | 400 | 1000 | 992 | 910 | 870 | 853 | 874 | 935 | 800 | 1800 | 1775 | 1712 | 1735 | 1650 | 1630 | 1600 | 895 | 400 | 265 | 200 | 350 | 325 | 349 | 898 | 1696 |
| 1200 | 1600 | 500 | 1200 | 993.5*2 | 1110 | 1070 | 454*2 | 474*2 | 1135 | 1000 | 1600 | 1575 | 1512 | 1535 | 1450 | 1430 | 1400 | 795 | 500 | 365 | 300 | 450 | 425 | 449 | 1098 | 1496 |
| 1200 | 1800 | 400 | 1200 | 993.5*2 | 1110 | 1070 | 454*2 | 474*2 | 1135 | 1000 | 1800 | 1775 | 1712 | 1735 | 1650 | 1630 | 1600 | 895 | 400 | 265 | 200 | 350 | 325 | 349 | 1098 | 1696 |
| 1200 | 2000 | 500 | 1200 | 993.5*2 | 1110 | 1070 | 454*2 | 474*2 | 1135 | 1000 | 2000 | 1975 | 1912 | 1935 | 1850 | 1830 | 1800 | 995 | 500 | 365 | 300 | 450 | 425 | 449 | 1098 | 1896 |

细节图

Detail Drawing

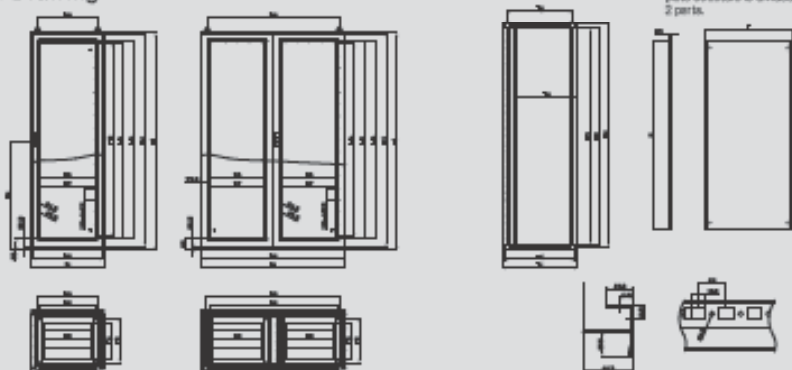

*B1: 宽度 ≥ 1200 时, 底部走线板结构分为左右 2 部分。

*B1: ≥ 1200 width, the bottom wiring insert plate structure is divided into left and right 2 parts.

- B1: 总宽度
 B2: 门内宽度
 B3: 箱体前屏内物宽度
 B5: 底座与地面固定前屏连接孔
 B6: 门板左侧方管加强肋距左右侧中心距离
 B7: 门板右侧方管加强肋距左右侧中心距离
 B8: 两个系统之间的侧内距离
 B9: 门板开缝宽度
 T1: 总深度

- T2: 底座与地面固定前屏连接孔
 T3: 门板开缝的厚度
 T4: 底座深度
 T5: 两个系统之间侧内距离
 T6: 安装板深度, 从 140mm 开始以每格 25mm 的距离进行调整
 H1: 总高度
 H2: 门和后背板的高度

- H3: 箱体前屏内的净高度
 H5: 上部与下部侧角之间的高度
 H6: 门板左侧方管加强肋距上下侧中心距离
 H7: 门板右侧方管加强肋距上下侧中心距离
 H8: 门板上下两个侧角之间的侧内固定方管
 H9: 门板侧门管中心点的距离
 F: 安装板的总宽度
 G: 安装板的总高度

- B1: Total width
 B2: Door width
 B3: Net width of the cabinet inner frame
 B5: The ground floor and lateral connections fixture holes
 B6: The left and right interior distance of the square tube reinforcing rib installation in the back of door plate
 B7: The left and right center distance of the square tube reinforcing rib in the back of door plate
 B8: The lateral distance between the two rings
 B9: Cabinet bottom slit width
 T1: Total depth

- T2: The front and back connection holes for the fixation of the bottom plate and ground
 T3: Depth of the slit in the cabinet bottom
 T4: Depth of the bottom frame
 T5: The distance between the center of the two rings
 T6: Mounting plate depth, the adjustment is from the beginning of the 140 mm in per 25 mm distance.
 H1: Total height
 H2: The height of the door and back plate

- H3: The net height in the frame of the cabinet bottom
 H5: The height of the upper and lower landscape shaped beam of the frame
 H6: The left and right center distance of the square tube reinforcing rib in the back of door plate
 H7: The left and right interior distance of the square tube reinforcing rib in the back of door plate
 H8: Upper and lower distance (fixed PVC) bolts between the two frames
 H9: Distance between the center of the bottom of the door to door
 F: Mounting plate width
 G: Mounting plate height

组合柜系列

Combined cabinet series



| | |
|--------------------------------|--|
| 材料 Material | 冷轧钢板 Cold-rolled steel sheet |
| 表面处理 Surface treatment | 机柜磷化电泳处理, 外帮为粉末涂装, 颜色可分RAL7032和RAL7035两种颜色, 安装板均为镀锌 Cabinet is applied with electrophoretic phosphating, and the outer side is covered with powder coating. Two color textures, RAL7032 and RAL7035, are available. The mounting plate is galvanized. |
| 防护等级 Protection grade | IP54 (按GB4205-1993和GB4205-1993) |
| 标准配置 Standard configuration | 前门、背板、安装板、柜体、密封条、门锁、侧板 (可选) Front door, back plate, mounting plate, cabinet body, sealing strip, door lock and side plate (optional) |
| 钢板厚度 Plate thickness | 底座: 九折型材1.5mm 门板: 2.0mm 背板、侧板: 1.5mm 安装板: 2.5mm Frame: nine-fold section 1.5mm Door plate: 2.0mm Back plate and side plate: 1.5mm Mounting plate: 2.5mm |



A3文件夹/顶位器
A3 folder/topper



方型角座
Corner of square



九折型材框架
Nine broken proximate metal framework

产品特点 Features of product

- 组合式电柜，适宜并柜使用
- 顶板可以移去，侧板可以拆卸，更易于工作的便捷性
- 门板离地面高，约25mm，确保开门灵活顺畅
- 独特的九折型材整体焊接而成的主体框架不但确保柜体的高强度而且使柜体的防护等级达到IP54
- 特殊的门板方管加强系统可以用螺丝固定在门板上，便于拆卸
- 框架上密布的25mm 间距模数孔确保安装的灵活性、通用性
- 镀锌安装板可以利用塑料滑块通过导轨从正面推入柜内，且两边有U型折边使安装板更牢固和更便于搬运
- Combined electric cabinet, suitable for combination
- The top plate is removable and the side plate is demountable, making work easier and simpler
- Ground clearance of door plate is sufficient, about 25mm, ensuring flexibility and smoothness of door opening.
- IP54The main body frame specially made of nine-fold section by means of whole welding not only ensures high strength of cabinet body but also lets the protection grade of cabinet body reach IP54.
- Special door plate square pipe reinforcement system can be fixed on the door plate with screws, easy for dismantlement.
- Module holes densely distributed at 25mm spacing on the frame guarantee the flexibility and universality of installation
- The mounting plate can be pushed into the cabinet from the front through guide rail by making use of plastic sliders. U-shape folded edges at the two sides facilitate fastening and handling of the mounting plate.

订货规格表
order specification table*可定制非标产品
Nonstandard products are customizable

| 序号 No. | 订货号 (PS) Order number (PS) | 订货号 (PS) Order number (PS) | 宽 Width | 高 Height | 深 Depth | 侧板订货号 (RAL7032) | 侧板订货号 (RAL7035) |
|-----------|---------------------------------|---------------------------------|---------|----------|---------|-------------------|----------------------|
| 1 | PS601840600 | PS601840500 | 600 | 1800 | 400 | PS1840600 | PS1840500 |
| 2 | PS601850600 | PS601850500 | 600 | 1800 | 500 | PS1850600 | PS1850500 |
| 3 | PS601860600 | PS601860500 | 600 | 1800 | 600 | PS1860600 | PS1860500 |
| 4 | PS602040600 | PS602040500 | 600 | 2000 | 400 | PS2040600 | PS2040500 |
| 5 | PS602050600 | PS602050500 | 600 | 2000 | 500 | PS2050600 | PS2050500 |
| 6 | PS602060600 | PS602060500 | 600 | 2000 | 600 | PS2060600 | PS2060500 |
| 7 | PS602080600 | PS602080500 | 600 | 2000 | 800 | PS2080600 | PS2080500 |
| 8 | PS602260600 | PS602260500 | 600 | 2200 | 600 | PS2260600 | PS2260500 |
| 9 | PS801840600 | PS801840500 | 800 | 1800 | 400 | PS1840600 | PS1840500 |
| 10 | PS801850600 | PS801850500 | 800 | 1800 | 500 | PS1850600 | PS1850500 |
| 11 | PS801860600 | PS801860500 | 800 | 1800 | 600 | PS1860600 | PS1860500 |
| 12 | PS802040600 | PS802040500 | 800 | 2000 | 400 | PS2040600 | PS2040500 |
| 13 | PS802050600 | PS802050500 | 800 | 2000 | 500 | PS2050600 | PS2050500 |
| 14 | PS802060600 | PS802060500 | 800 | 2000 | 600 | PS2060600 | PS2060500 |
| 15 | PS802080600 | PS802080500 | 800 | 2000 | 800 | PS2080600 | PS2080500 |
| 16 | PS802260600 | PS802260500 | 800 | 2200 | 600 | PS2260600 | PS2260500 |
| 17 | PS101840600 | PS101840500 | 1000 | 1800 | 400 | PS1840600 | PS1840500 |
| 18 | PS121840600 | PS121840500 | 1200 | 1800 | 400 | PS1840600 | PS1840500 |
| 19 | PS121850600 | PS121850500 | 1200 | 1800 | 500 | PS1850600 | PS1850500 |
| 20 | PS121860600 | PS121860500 | 1200 | 1800 | 600 | PS1860600 | PS1860500 |
| 21 | PS122040600 | PS122040500 | 1200 | 2000 | 400 | PS2040600 | PS2040500 |
| 22 | PS122050600 | PS122050500 | 1200 | 2000 | 500 | PS2050600 | PS2050500 |
| 23 | PS122060600 | PS122060500 | 1200 | 2000 | 600 | PS2060600 | PS2060500 |
| 24 | PS122080600 | PS122080500 | 1200 | 2000 | 800 | PS2080600 | PS2080500 |
| 25 | PS122260600 | PS122260500 | 1200 | 2200 | 600 | PS2260600 | PS2260500 |
| 26 | PS102050600 | PS102050500 | 1000 | 2000 | 500 | PS2050600 | PS2050500 |
| 27 | PS102060600 | PS102060500 | 1000 | 2000 | 600 | PS2060600 | PS2060500 |

*PS系列细节图见43页 *See Page 43 for PS Series Detail Drawing

不锈钢组合柜系列

Stainless steel combined cabinet series



| | |
|--------------------------------|--|
| 材料 Material | SUS304 (其它材料型号可选) SUS304 (other material types are optional) |
| 表面处理 Surface treatment | 拉丝, 安装板则为镀锌 drawing, and mounting plate is galvanized |
| 防护等级 Protection grade | IP54 (按GB4205-1993) IP54 (in accordance with GB4205-1993) |
| 标准配置 Standard configuration | 前门、背板、安装板、柜体、密封条、门锁、侧板(可选件) Front door, back plate, mounting plate, cabinet body, sealing strip, door lock and side plate (optional) |
| 钢板厚度 Plate thickness | 框架: 九折型材1.5mm 门板: 2.0mm 背板、侧板: 1.5mm 安装板: 2.5mm Frame nine-fold section 1.5mm Door plate: 2.0mm Back plate and side plate 1.5mm Mounting plate: 2.5mm |



限位器/铰链/加强方管
Stopper/hinge/
reinforced square pipe



固定底座
Fixing base



不锈钢三通连接件
Stainless steel three-way connection element

产品特点 Features of product

- 组合式电柜，适宜并柜使用
- 顶板可以移去，侧板可以脱卸，更易于工作的便捷性
- 门板离地面高，约25mm，确保开门灵活顺畅
- 独特的九折型材配合高强度的不锈钢三通连接件焊接而成的主体框架确保柜体的高强度
- 特殊的门板方管加强系统可以用螺丝固定在门板上，便于拆卸
- 框架上密布的25mm 间距模数孔确保安装的灵活性、通用性
- 镀锌安装板可以利用塑料滑块通过导轨从正面推入柜内，且两边有U型折边使安装板更牢固和更便于搬运
- 专业的不锈钢防盗锁、不锈钢承重吊环以及各种功能性的附件彰显柜体豪华品质

- Combined electric cabinet, suitable for combination
- The top plate is removable and the side plate is demountable, making work easier and simpler
- Ground clearance of door plate is sufficient, about 25mm, ensuring flexibility and smoothness of door opening.
- The main body frame specially made of nine-fold section and high-strength stainless steel three-way connection elements through welding ensures high strength of cabinet body.
- Special door plate square pipe reinforcement system can be fixed on the door plate with screws, easy for dismantlement.
- Module holes densely distributed at 25mm spacing on the frame guarantee the flexibility and universality of installation
- The mounting plate can be pushed into the cabinet from the front through guide rail by making use of plastic sliders. U-shape folded edges at the two sides facilitate fastening and handling of the mounting plate.
- Professional stainless steel turnoff lock, stainless steel bearing suspension loops and other accessories bring out luxury character of cabinet body.

订货规格表

order specification table

*可定制非标产品
Nonstandard products are customizable

| 序号 No. | 订货号 Order number | 宽 Width | 高 Height | 深 Depth | 侧板订货号 |
|-----------|---------------------|---------|----------|---------|---------|
| 1 | 601840304 | 600 | 1800 | 400 | 1840304 |
| 2 | 601850304 | 600 | 1800 | 500 | 1850304 |
| 3 | 601860304 | 600 | 1800 | 600 | 1860304 |
| 4 | 602040304 | 600 | 2000 | 400 | 2040304 |
| 5 | 602050304 | 600 | 2000 | 500 | 2050304 |
| 6 | 602060304 | 600 | 2000 | 600 | 2060304 |
| 7 | 602080304 | 600 | 2000 | 800 | 2080304 |
| 8 | 602260304 | 600 | 2200 | 600 | 2260304 |
| 9 | 801840304 | 800 | 1800 | 400 | 1840304 |
| 10 | 801850304 | 800 | 1800 | 500 | 1850304 |
| 11 | 801860304 | 800 | 1800 | 600 | 1860304 |
| 12 | 802040304 | 800 | 2000 | 400 | 2040304 |
| 13 | 802050304 | 800 | 2000 | 500 | 2050304 |
| 14 | 802060304 | 800 | 2000 | 600 | 2060304 |
| 15 | 802080304 | 800 | 2000 | 800 | 2080304 |
| 16 | 802260304 | 800 | 2200 | 600 | 2260304 |
| 17 | 101840304 | 1000 | 1800 | 400 | 1840304 |
| 18 | 121840304 | 1200 | 1800 | 400 | 1840304 |
| 19 | 121850304 | 1200 | 1800 | 500 | 1850304 |
| 20 | 121860304 | 1200 | 1800 | 600 | 1860304 |
| 21 | 122040304 | 1200 | 2000 | 400 | 2040304 |
| 22 | 122050304 | 1200 | 2000 | 500 | 2050304 |
| 23 | 122060304 | 1200 | 2000 | 600 | 2060304 |
| 24 | 122080304 | 1200 | 2000 | 800 | 2080304 |
| 25 | 122260304 | 1200 | 2200 | 600 | 2260304 |
| 26 | 102050304 | 1000 | 2000 | 500 | 2050304 |
| 27 | 102060304 | 1000 | 2000 | 600 | 2060304 |

*细节图见43页 *See Page 43 for Detail Drawing

尺寸规格表
dimension table

| 规格尺寸 Dimension | | | 宽度 Width | | | | | | | 高度 Height | | | | | | | 深度 Depth | | | | | | | 安装板 Mounting plate | |
|-------------------|-------------|------------|-------------|------|------|------|------|------|------|--------------|------|------|------|------|------|------|-------------|-----|-----|-----|-----|-----|-----|-----------------------|------|
| 宽 Width | 高 Height | 深 Depth | B1 | B2 | B3 | B5 | B6 | B7 | B8 | B9 | H1 | H2 | H3 | H5 | H6 | H7 | T1 | T2 | T3 | T4 | T5 | T6 | T7 | F | G |
| 600 | 1800 | 400 | 599 | 592 | 512 | 478 | 454 | 474 | 535 | 400 | 1800 | 1775 | 1712 | 1735 | 1650 | 1630 | 400 | 235 | 302 | 350 | 200 | 349 | 325 | 498 | 1696 |
| 600 | 1800 | 500 | 599 | 592 | 512 | 478 | 454 | 474 | 535 | 400 | 1800 | 1775 | 1712 | 1735 | 1650 | 1630 | 500 | 335 | 402 | 450 | 300 | 449 | 425 | 498 | 1696 |
| 600 | 1800 | 600 | 599 | 592 | 512 | 478 | 454 | 474 | 535 | 400 | 1800 | 1775 | 1712 | 1735 | 1650 | 1630 | 600 | 435 | 502 | 550 | 400 | 549 | 525 | 498 | 1696 |
| 600 | 2000 | 400 | 599 | 592 | 512 | 478 | 454 | 474 | 535 | 400 | 2000 | 1975 | 1912 | 1935 | 1850 | 1830 | 400 | 235 | 302 | 350 | 200 | 349 | 325 | 498 | 1896 |
| 600 | 2000 | 500 | 599 | 592 | 512 | 478 | 454 | 474 | 535 | 400 | 2000 | 1975 | 1912 | 1935 | 1850 | 1830 | 500 | 335 | 402 | 450 | 300 | 449 | 425 | 498 | 1896 |
| 600 | 2000 | 600 | 599 | 592 | 512 | 478 | 454 | 474 | 535 | 400 | 2000 | 1975 | 1912 | 1935 | 1850 | 1830 | 600 | 435 | 502 | 550 | 400 | 549 | 525 | 498 | 1896 |
| 600 | 2000 | 800 | 599 | 592 | 512 | 478 | 454 | 474 | 535 | 400 | 2000 | 1975 | 1912 | 1935 | 1850 | 1830 | 800 | 635 | 702 | 750 | 600 | 749 | 725 | 498 | 1896 |
| 600 | 2200 | 600 | 599 | 592 | 512 | 478 | 454 | 474 | 535 | 400 | 2200 | 2175 | 2112 | 2135 | 2050 | 2030 | 600 | 435 | 502 | 550 | 400 | 549 | 525 | 498 | 2096 |
| 800 | 1800 | 400 | 799 | 792 | 712 | 678 | 654 | 674 | 735 | 600 | 1800 | 1775 | 1712 | 1735 | 1650 | 1630 | 400 | 235 | 302 | 350 | 200 | 349 | 325 | 698 | 1696 |
| 800 | 1800 | 500 | 799 | 792 | 712 | 678 | 654 | 674 | 735 | 600 | 1800 | 1775 | 1712 | 1735 | 1650 | 1630 | 500 | 335 | 402 | 450 | 300 | 449 | 425 | 698 | 1696 |
| 800 | 1800 | 600 | 799 | 792 | 712 | 678 | 654 | 674 | 735 | 600 | 1800 | 1775 | 1712 | 1735 | 1650 | 1630 | 600 | 435 | 502 | 550 | 400 | 549 | 525 | 698 | 1696 |
| 800 | 2000 | 400 | 799 | 792 | 712 | 678 | 654 | 674 | 735 | 600 | 2000 | 1975 | 1912 | 1935 | 1850 | 1830 | 400 | 235 | 302 | 350 | 200 | 349 | 325 | 698 | 1896 |
| 800 | 2000 | 500 | 799 | 792 | 712 | 678 | 654 | 674 | 735 | 600 | 2000 | 1975 | 1912 | 1935 | 1850 | 1830 | 500 | 335 | 402 | 450 | 300 | 449 | 425 | 698 | 1896 |
| 800 | 2000 | 600 | 799 | 792 | 712 | 678 | 654 | 674 | 735 | 600 | 2000 | 1975 | 1912 | 1935 | 1850 | 1830 | 600 | 435 | 502 | 550 | 400 | 549 | 525 | 698 | 1896 |
| 800 | 2000 | 800 | 799 | 792 | 712 | 678 | 654 | 674 | 735 | 600 | 2000 | 1975 | 1912 | 1935 | 1850 | 1830 | 800 | 635 | 702 | 750 | 600 | 749 | 725 | 698 | 1896 |
| 800 | 2200 | 600 | 799 | 792 | 712 | 678 | 654 | 674 | 735 | 600 | 2200 | 2175 | 2112 | 2135 | 2050 | 2030 | 600 | 435 | 502 | 550 | 400 | 549 | 525 | 698 | 2096 |
| 1000 | 1800 | 400 | 999 | 992 | 912 | 878 | 854 | 874 | 935 | 800 | 1800 | 1775 | 1712 | 1735 | 1650 | 1630 | 400 | 235 | 302 | 350 | 200 | 349 | 325 | 898 | 1696 |
| 1200 | 1800 | 400 | 1199 | 1192 | 1112 | 1078 | 1054 | 1074 | 1135 | 1000 | 1800 | 1775 | 1712 | 1735 | 1650 | 1630 | 400 | 235 | 302 | 350 | 200 | 349 | 325 | 1098 | 1696 |
| 1200 | 1800 | 500 | 1199 | 1192 | 1112 | 1078 | 1054 | 1074 | 1135 | 1000 | 1800 | 1775 | 1712 | 1735 | 1650 | 1630 | 500 | 335 | 402 | 450 | 300 | 449 | 425 | 1098 | 1696 |
| 1200 | 1800 | 600 | 1199 | 1192 | 1112 | 1078 | 1054 | 1074 | 1135 | 1000 | 1800 | 1775 | 1712 | 1735 | 1650 | 1630 | 600 | 435 | 502 | 550 | 400 | 549 | 525 | 1098 | 1696 |
| 1200 | 2000 | 400 | 1199 | 1192 | 1112 | 1078 | 1054 | 1074 | 1135 | 1000 | 2000 | 1975 | 1912 | 1935 | 1850 | 1830 | 400 | 235 | 302 | 350 | 200 | 349 | 325 | 1098 | 1896 |
| 1200 | 2000 | 500 | 1199 | 1192 | 1112 | 1078 | 1054 | 1074 | 1135 | 1000 | 2000 | 1975 | 1912 | 1935 | 1850 | 1830 | 500 | 335 | 402 | 450 | 300 | 449 | 425 | 1098 | 1896 |
| 1200 | 2000 | 600 | 1199 | 1192 | 1112 | 1078 | 1054 | 1074 | 1135 | 1000 | 2000 | 1975 | 1912 | 1935 | 1850 | 1830 | 600 | 435 | 502 | 550 | 400 | 549 | 525 | 1098 | 1896 |
| 1200 | 2000 | 800 | 1199 | 1192 | 1112 | 1078 | 1054 | 1074 | 1135 | 1000 | 2000 | 1975 | 1912 | 1935 | 1850 | 1830 | 800 | 635 | 702 | 750 | 600 | 749 | 725 | 1098 | 1896 |
| 1200 | 2200 | 600 | 1199 | 1192 | 1112 | 1078 | 1054 | 1074 | 1135 | 1000 | 2200 | 2175 | 2112 | 2135 | 2050 | 2030 | 600 | 435 | 502 | 550 | 400 | 549 | 525 | 1098 | 2096 |
| 1000 | 2000 | 500 | 999 | 992 | 912 | 878 | 854 | 874 | 935 | 800 | 2000 | 1975 | 1912 | 1935 | 1850 | 1830 | 500 | 335 | 402 | 450 | 300 | 449 | 425 | 898 | 1896 |
| 1000 | 2000 | 600 | 999 | 992 | 912 | 878 | 854 | 874 | 935 | 800 | 2000 | 1975 | 1912 | 1935 | 1850 | 1830 | 600 | 435 | 502 | 550 | 400 | 549 | 525 | 898 | 1896 |

细节图

detail drawing

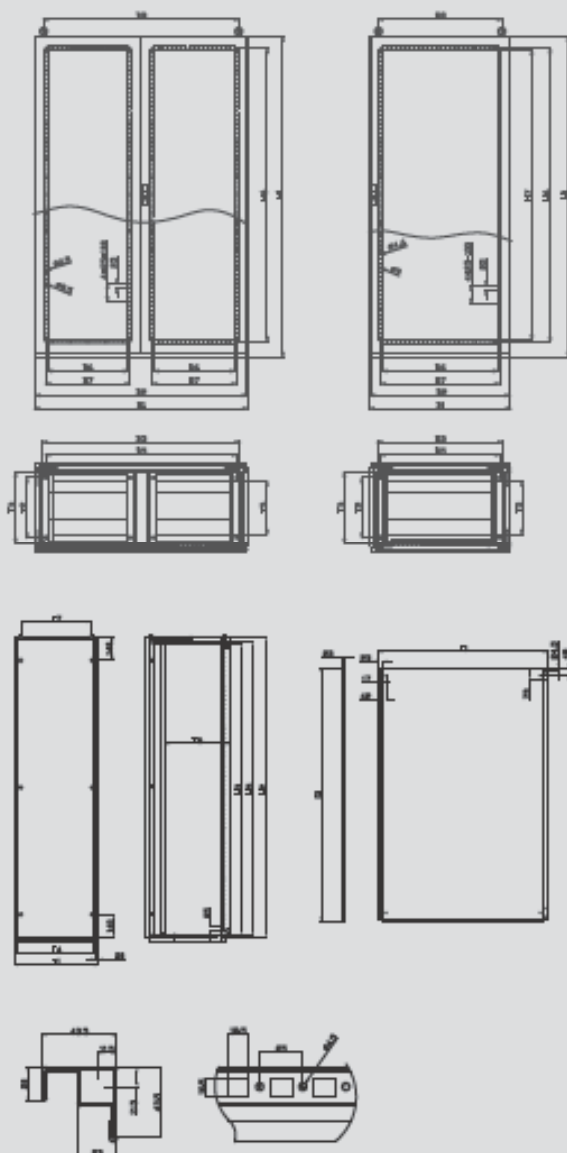

*B1: 宽度≥1200时, 底部前板新结构分左右2部分。
*B1: ≥1200 width, the bottom line board structure at around 2 parts.

- B1: 总宽度 (不含侧板, 框架外框尺寸)
- B2: 门的宽度
- B3: 箱体框架内的净宽度
- B5: 柜体下纵梁与底板对应孔 (无底座, 此孔与地面相连接)
- B6: 门板后部方管加强筋左右侧内框距离
- B7: 门板后部方管加强筋左右侧中心距离
- B8: 两个吊环之间的距离
- B9: 箱体开缝宽度
- T1: 总深度
- T2: 底板与地面固定物前后连接孔
- T3: 底框内的净深度
- T4: 底框深度
- T5: 箱体开缝的深度
- T6: 安装板厚度, 从140mm开始以每格25mm的距离进行调节
- T7: 两个吊环中心点之间的距离
- H1: 总高度
- H2: 门和后背板的高度
- H3: 箱体框架内的净高度
- H5: 框架上下横向往型材梁之间的高度
- H6: 门板后部方管加强筋上下侧中心距离
- H7: 门板后部方管加强筋上下侧内框距离
- F: 安装板的总宽度
- G: 安装板的总高度
- B1: Total width (Excluding the lateral plate, the outer frame size)
- B2: Door width
- B3: Net width of the cabinet inner frame
- B5: Corresponding hole of longitudinal beam beneath cabinet and bottom plate(Without base, this hole connected to the ground)
- B6: The left and right interior distance of the square tube reinforcing rib installation in the back of door plate
- B7: The left and right center distance of the square tube reinforcing rib in the back of door plate
- B8: The distance between the two rings
- B9: Cabinet bottom slit width
- T1: Total depth
- T2: The front and back connection holes for the fixation of the Bottom plate and ground
- T3: Net depth in the bottom frame
- T4: Depth of the bottom frame
- T5: Depth of the slit in the cabinet bottom
- T6: Mounting plate depth, the adjustment is from the beginning of the 140 mm in per 25 mm distance.
- T7: The distance between the center of the two rings
- H1: Total height
- H2: The height of the door and back plate
- H3: The net height in the frame of the cabinet bottom
- H5: The height of the upper and lower landscape Shaped beam of the frame
- H6: The left and right center distance of the square tube reinforcing rib in the back of door plate
- H7: The left and right interior distance of the square tube reinforcing rib in the back of door plate
- F: Mounting plate width
- G: Mounting plate height

IP防护类别是用2个数字标记的 IP protection grade is marked with 2 digits.

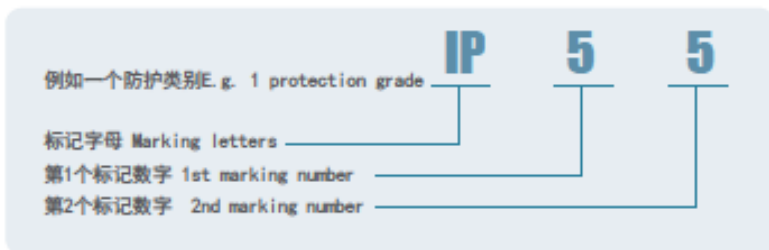

接触保护盒外来物保护等级 — 第1个标记数字 The first number of a marker

| 第1个标记数字 1st tag number | 防护范围 Protection range | |
|---------------------------|---|---|
| | 名称 Name | 说明 Remarks |
| 0 | 无防护 No protection | |
| 1 | 防护50mm直径和更大的外来物体 Protection against foreign objects 50mm and larger in diameter | 探测器, 球体直径为50mm不应完全进入* Detector, sphere diameter is 50mm, which should not enter completely |
| 2 | 防护12.5mm直径和更大的外来物体 Protection against foreign object 12.5mm and larger in diameter | 探测器, 球体直径为12.5mm不应完全进入* Detector, sphere diameter is 12.5mm, which should not enter completely |
| 3 | 防护2.5mm直径和更大的外来物体 Protection against foreign object 2.5mm and larger in diameter | 探测器, 球体直径为2.5mm不应完全进入* Detector, sphere diameter is 2.5mm, which should not enter completely |
| 4 | 防护1.0mm直径和更大的外来物体 Protection against foreign object 1.0mm and larger in diameter | 探测器, 球体直径为1.0mm不应完全进入* Detector, sphere diameter is 1.0mm, which should not enter completely |
| 5 | 防护灰尘 Dust prevention | 不可能完全阻止灰尘进入, 但是灰尘的进入量不应超过这样的数量, 既对装置或者安全造成损害 It can not completely prevent dust from entering, but the amount of dust shall not exceed such amount, which will be harm to both the device or the safety. |
| 6 | 防尘封闭 Dust enclosed | 箱体内在20毫巴的低压时不应侵入灰尘 The cabinet body should be able to prevent dust at the low pressure of 20millibars. |

接触保护盒外来物保护等级 — 第2个标记数字 The second number of a marker

| 第2个标记数字 2nd marking number | 防护范围 Protection range | |
|-------------------------------|---|---|
| | 名称 Name | 说明 Remarks |
| 0 | 无防护 No protection | |
| 1 | 水滴防护 Water drop protection | 垂直下落的水滴不应引起损害 The vertically-dropped water drops should not cause harm. |
| 2 | 箱体倾斜15°时, 防护水滴 Protect against the water drops at the 15° tilting degree of cabinet body | 箱体内任何一侧倾斜至15°时, 垂直落地水滴不应引起损害 When any side of the body tilts to 15°, the vertically-dropped water drops should not cause any damage. |
| 3 | 防护溅出的水 Protect against the spilled water | 以60°角从垂直线两侧溅出的水不应引起损害 Water splashed from both sides of the vertical lines at 60° angle should not cause damage. |
| 4 | 防护喷水 Protection against water spray | |
| 5 | 防护射水 Protection against water jetting | 以每个方向对准箱体的射水都不应引起损害 Any water spray facing directly to the cabinet body should not cause any damage. |
| 6 | 防护强射水 Protection against strong water jetting | |
| 7 | 防护短时间浸入水中 Protection against immersing into water in a short time | 箱体在标准压力下短时间浸入水中时, 不应有能引起有害作用的水量浸入箱体 Cabinet immersing into water for a short time under standard pressure should not cause any harmful amount of water entering the body. |
| 8 | 防护长时间浸入水中 Protection dips into water in a long time | 箱体必须在由制造商和用户协商定出的条件下长期浸入水中, 不应有能引起有害作用的水量浸入, 但这些条件必须比标记数字7所规定的复杂 The cabinet should be immersed into water under the conditions agreed by the manufacturer and user. No harmful amount of water should enter the body, however, these conditions should be more complicated than the one stipulated in marking number 7. |

在考虑安装场所的环境后选择机箱是安全使用产品的关键。
 防护等级 (IP) 表示根据环境选用机箱时必须考虑的产品对固体异物和水的防护性能。
 机箱工业协会规定了选择符合安装场所要求的产品时所需考虑的推荐防护等级。
 而且, 推荐 IP 还考虑到了实际产品市场上的 IP 值。

选择方法

- 1 根据安装场所在室内或室外选择要使用的表。
- 2 选择一般场所或存在不同程度灰尘等的环境。
- 3 选择受到水、雨等不同程度影响的环境。

室内安装

| 有人接近危险部件或存在固体物的环境 | 一般场所 (一般生活环境) | | 尘埃较少的场所 (虽有尘埃, 但无需配带防尘面罩的场所) | | 尘埃较多的场所 (佩戴防尘面罩进行作业的环境) | |
|-------------------|---------------|---------------------------------|------------------------------|-------------|-------------------------|----------------------------|
| | IP | 安装场所示例 | IP | 安装场所示例 | IP | 安装场所示例 |
| 有水的环境 | IP | 住宅、事务所、店铺、组装工厂 | IP | 缝制厂、螺丝厂、制纸厂 | IP | 制材厂、制粉厂、石加工厂、陶器厂 |
| 无潮气的场所 | 2X | | 4X | | 5X | |
| 有滴水影响的场所 (防滴型) | 21 | 管道竖井、地下室、地道 | 41 | 地下室 | 54 | ----- |
| 上方有飞沫喷射的场所 | 23 | 开放型人口大厅 | 43 | ----- | 54 | ----- |
| 上下方有飞沫喷射的场所 | 44 | 食品厂、电镀厂、养猪厂等有飞沫上下喷射的场所 | | | 54 | 食品厂、电镀厂、清洗厂、养鸡厂等有飞沫上下喷射的场所 |
| 通过软管喷洒清洁水的场所 | 55 | 食品厂、厨房、浴室、室内游泳池、温室等通过软管喷洒清洁水的场所 | | | | |

室外安装

| 有人接近危险部件或存在固体物的环境 | 一般场所 (一般生活环境) | | 尘埃较少的场所 (尘埃飞扬的室外场所等) | | 尘埃较多的场所 (采矿现场等粉尘较多的场所) | |
|---|---------------|------------------|----------------------|----------|------------------------|--------|
| | IP | 安装场所示例 | IP | 安装场所示例 | IP | 安装场所示例 |
| 有水的环境 | IP | 建筑物外壁、屋檐下、公园 | IP | 运动场两侧屋檐下 | IP | ----- |
| 上方有雨水滴落的场所、雨带内 (防雨型: 斜上方不暴露在风雨中的室外场所) | 23 | | 43 | | 54 | |
| 横向或斜上方有风雨带来的水沫喷射的场所 (防沫型: 暴露在风雨中的室外场所) | 44 | 屋顶、降雪地、运动场 | | | 54 | ----- |
| 横向或斜上方有暴风雨带来的喷水的场所 (防喷流型: 铁塔上或软管上喷水的场所) | 55 | 高耸的铁塔上、室外游泳池、洗车场 | | | 66 | 采矿场 |
| 可能被水淹没的场所 (防浸型: 池塘两侧可能会暂时浸水的场所) | 67 | 下水道、河岸地、池塘 | | | | |

- 注 1) 上述防护等级 (IP) 表示安装场所中的最低值。建议在选择时根据安装场所留有余量。
 注 2) 安装场所示例中的各种环境均假设为一般环境。请根据实际的使用环境进行选择。
 注 3) 如果没有要选择的机箱, 请选择更高等级的产品。
 注 4) 施工时, 请先阅读“机箱施工注意事项” (由机箱标准化协会及机箱工业会发布), 然后正确施工。

实现高品质的喷涂性能

质管通过贯彻品质和采用国际先进工艺的喷涂方法实现高品质！

喷涂工艺

采用电沉积（底漆）+粉末喷涂（面漆）来达到机箱表面的高性能。

脱脂

对材料表面进行喷涂前，先进行表面处理，除去钣金表面的杂质和涂料不相溶的油污。



化学合成保护膜处理

材料表面因化学反应而生成的保护膜，可增加腐蚀性和提高喷涂时粉末的附着力



电泳底漆

把箱体浸入装满水溶解涂料的容器中，然后加直流电压，是涂料中的树脂，颜料在箱体表面析出，形成涂膜。使机箱涂层均匀，包括棱角和空腔也能喷涂到。



粉末喷涂（面漆）

将树脂和颜料的混合物固化，研磨成粉末，然后附着在被机柜上，经过烘烤后形成涂膜。在喷涂过程中，使粉末带上静电，并将机柜接地，使粉末涂料被吸附到机柜表面，通过静电喷涂方式获得高性能，美观的喷涂效果。

喷涂工艺

高品质

- 由于不使用溶剂，因此可以利用涂料中使用的树脂特性获得高性能、高膜厚的涂膜，同时拥有优异的附着性、防腐性、耐盐性、耐候性、耐化学品性和电气绝缘性。
- 喷涂时容易发生的涂膜不良现象（下垂、流挂、底层露出、针孔、凹陷、色散等）大幅减少。

低污染

- 由于粉末涂料是无溶剂涂料，因此大大减少了溶剂引起的公害问题以及火灾、爆炸和中毒的危险，而且不会发生废水处理问题。另外，与溶剂型涂料相比，作业环境大大改善。

节约资源

- 涂料可回收再利用，因此涂料损失很小，同时减少了工业废弃物。

根据时间和场所的不同，安装环境可能是特殊环境

机箱的喷涂一般是为了达到美观、防腐蚀的效果。根据使用场所的不同，涂膜可能会暴露在恶劣腐蚀性环境下，因此其防腐性能关系到机箱自身的使用寿命。尽管涂膜的防腐性能是选择机箱的重要因素，但目前的现状是各制造商都遵循各自的基准。为了在安装环境下选择最佳的喷涂质量，机箱标准化协会制定了相关基准。

海岸地带

1. 避开海风的地方 —— 耐盐规格距离海岸约 300m 到 1km 以内
2. 海风直接吹拂的地方 —— 重耐盐规格距离海岸约 300m 以内

腐蚀性气体环境

1. 产生酸性气体的地方 —— 耐酸规格
2. 产生碱性气体的地方 —— 耐碱规格

不同安装场所、环境的防锈性能要求等级和判断基准

喷涂的基底、预处理和涂料决定了涂膜的质量水准。下表中列出了国家相关标准所规定的众多性能中，对防腐的质量评估特别有效的性能。

| 规格 | 一般环境 | | 特殊环境 | | | |
|--------|---|------------------------|----------------------------|-------------------------|--|---|
| | 室内规格 | 室外规格 | 耐盐规格 | 重耐盐规格 | 耐酸规格 | 重耐酸规格 |
| 使用环境示例 | ●一般室内 | ●一般室外、屋侧 | ●距离海岸约 300m 到 1km 以内的室外、屋侧 | ●距离海岸约 300m 以内的室外、屋侧 | ●产生酸性气体的场所（化工厂、食品等） ●重工业地带、温泉等产生特殊气体的场所 | ●产生碱性气体的场所（化工厂、食品等） ●重工业地带、温泉等产生特殊气体的场所 |
| 性能 | 耐盐雾性 120h(5 cycle) | 耐盐雾性 240h(10 cycle) | 耐盐雾性 500h(20 cycle) | 耐盐雾性 1000h(40 cycle) | 耐酸性 120h | 耐碱性 120h |
| 试验方法 | ●用切割刀的刀尖在试片的涂膜中央沿长边划出一条长 100mm 的直线（从涂膜表面一直到基底），将试片在 5%NaCl(35℃) 的连续喷雾下放置规定的时间后进行判断。或者，先进行规定次数的 16 小时喷雾和 8 小时休止的循环，再在室内放置 2 小时后进行判断。 | | | | 5% H_2SO_4 先在 (20℃) 的溶液中浸泡规定时间，再在室内放置 2 小时后进行判断。 | 5% Na_2CO_3 先在 (20℃) 的溶液中浸泡规定时间，再在室内放置 2 小时后进行判断。 |
| 判断基准 | ●对涂膜表面有无锈迹、隆起或剥落及其程度进行检查。 ●对胶带沿切割线粘贴和剥离时的单侧剥落宽度进行检查。 120h 以下：2mm 以下 240h 以上：3mm 以下 | | | | ●取出试片后立刻以及放置 2 小时后目视观察，未发现涂膜隆起、裂纹、剥落、针孔、软化和生锈，而且浸泡溶液没有着色或浑浊，与原状试片相比光泽变化或变色程度都不大。 | |

材料的种类及基本特性

备注：材料的种类及基本特性只是列出普通材质的数值，请注意

钢铁

| 材质型号 | 名称 | 拉伸强度 N/mm ² | 延伸值 % | 特征 |
|--------|--------|------------------------|-------|-------------------------|
| SPOC | 冷轧钢板 | 37 以上 | 7.85 | 主要用作薄钢的普通钢板，经过电镀或者喷涂后使用 |
| SPHC | 热轧钢板 | 29 以上 | 7.85 | 主要用作薄钢的普通钢板，经过电镀或者喷涂后使用 |
| SECC | 镀锌钢板 | 37 以上 | 7.85 | 对冷轧钢板进行镀锌处理而成 |
| SEHC | 镀锌钢板 | 29 以上 | 7.85 | 对冷轧钢板进行镀锌处理而成 |
| SUS304 | 奥氏体不锈钢 | 40 以上 | 93 | 耐腐蚀性，耐候性，焊接线优良的普通不锈钢 |

铝合金

| 材质型号 | 名称 | 拉伸强度 N/mm ² | 延伸值 % | 特征 |
|--------|------|------------------------|-------|------------------------|
| A5052P | 板材 | 215-265 | 7 以上 | 加工型，焊接线，耐腐蚀性优异 |
| A6063 | 挤压材料 | 155 以上 | 8 以上 | 强度，耐腐蚀性，挤压性能优良 |
| ZL102 | 压铸件 | 296 以上 | 2 以上 | 铸造性能优良，气密性较高，密度小，耐腐蚀性好 |

橡胶(密封条)

| 材质型号 | 名称 | 使用温度范围℃ | 耐热老化性 | 耐油性 | 耐水性 | 耐酸性 | 耐碱性 | 阻燃性 |
|------|-------|------------|-------|-----|-----|-----|-----|-----|
| UR | 聚氨酯橡胶 | -30 - +80 | 可以 | 良 | 良 | 不可以 | 可以 | 可以 |
| Si | 硅橡胶 | -70 - +280 | 优 | 可以 | 优 | 优 | 优 | 良 |



注意安全

安装施工注意事项：

- 1、请在参阅产品目录内容（IP，材质等）的基础上，选择适合设备性能的工作环境。
- 2、请确认底座安装面的水平状况，使用合适的地脚螺栓牢固安装。并且，请根据需要采取防止翻到的措施。
- 3、须牢固的安装机箱，主要箱内设备的自重，以免机箱从墙壁上掉落或翻到。
- 4、起吊立式机柜时，请务必从 4 个点（附带 2 个吊环螺栓的机箱起吊点 2 个）起吊，并且起吊时的吊绳角度应大于 45 度，使机箱保持平衡。
- 5、加工机箱的穿线孔时，请采取防护措施，防止切屑和异物混入机箱。如果切屑和异物混入机箱，则可能导致触电或故障。
- 6、室外型机箱的贯通部位恐有进水的危险，请进行防水处理。
- 7、请将接地线完全连接到接线端子上。

声明：

因对产品改进或升级，可能会产生新的规格型号，产品有所变化，敬请谅解。

有可能在印刷中产生错误，最终以本公司合约为准。

有关价格，交货期，产品技术图纸等详情请向本公司来电咨询。

| | | | | | | | |
|--|--|---|---|--------------------------------------|--|--------------------------------------|--------------------------------------|
| | | | | | | | |
| RAL5000 Blue green 蓝绿色 | RAL5005 Blue green 蓝绿色 | RAL5010 Grey olive 橄榄灰绿色 | RAL5015 Slate green 板岩绿 | RAL5020 Fir green 冷杉绿 | RAL5025 Grass green 草绿色 | RAL5030 Teal green 海绿 | RAL5035 Red green 红绿色 |
| | | | | | | | |
| RAL5040 Yellow olive 黄橄榄 | RAL5045 Black olive 黑橄榄绿色 | RAL5050 Turquoise green 绿松石绿色 | RAL5055 May green 五月绿 | RAL5060 Yellow green 黄绿色 | RAL5065 Pastel green 淡黄绿色 | RAL5070 Ring Green 碧绿色 | RAL5075 Light green 浅绿色 |
| | | | | | | | |
| RAL5080 Ivory green 象牙绿 | RAL5085 Fawn green 黄褐色 | RAL5090 Dust green 蓝灰绿色 | RAL5095 Light green 浅绿 | RAL6000 Pine green 松绿色 | RAL6005 Slate green 板岩绿 | RAL6010 Signal green 信号绿 | RAL6015 Slate turquoise 板岩绿松石色 |
| | | | | | | | |
| RAL6020 (金鼠须) Pearl green 珍珠绿 | RAL6025 (金鼠须) Opaque blue and green 不透明蓝绿色 | RAL7000 Grey asphalt 灰鼠须 | RAL7005 Silver 银灰色 | RAL7010 Olive gray-green 橄榄灰绿色 | RAL7015 Blue gray 蓝鼠须 | RAL7020 Signal gray 信号灰 | RAL7025 Slate gray 鼠须灰 |
| | | | | | | | |
| RAL7030 Schwartz braun and gray 上黑灰色 | RAL7035 Green gray 绿灰色 | RAL7040 Turquoise gray 蓝绿色 | RAL7045 Iron gray 铁灰色 | RAL7050 Slate blue line 安武石灰 | RAL7055 Brown gray 褐灰色 | RAL7060 Light olive gray 浅橄榄灰 | RAL7065 Dust ash 鼠须 |
| | | | | | | | |
| RAL7070 Dark gray 暗灰 | RAL7075 Dusky blue gray 蓝鼠须 | RAL7080 Slate blue gray 蓝鼠须 | RAL7085 Slate blue gray 蓝鼠须 | RAL7090 Slate blue gray 蓝鼠须 | RAL7095 Blue gray 蓝鼠须 | RAL8000 Ruhle's gray 鲁赫尔灰 | RAL8005 Slate gray 鼠须灰 |
| | | | | | | | |
| RAL8010 Light gray 浅灰色 | RAL8015 Platinum gray 铂灰色 | RAL8020 Grey ash 土灰色 | RAL8025 Slate gray 鼠须灰 | RAL8030 Slate gray 鼠须灰 | RAL8035 Slate gray 鼠须灰 | RAL8040 Slate gray A 鼠须灰 A | RAL8045 Slate gray B 鼠须灰 B |
| | | | | | | | |
| RAL8050 TV Gray 1 电视灰 1 | RAL8055 TV Gray 2 电视灰 2 | RAL8060 TV Gray 4 电视灰 4 | RAL8065 (金鼠须) Pearl gray mouse 珍珠鼠须 | RAL8070 Green brown 绿褐色 | RAL8075 Slate brown 鼠须褐色 | RAL8080 Signal brown 信号褐色 | RAL8085 Brown ash 土褐色 |
| | | | | | | | |
| RAL8090 Brown Beer 啤酒色 | RAL8095 Olive brown 橄榄褐色 | RAL9000 Dark brown 深褐色 | RAL9005 Red brown 红褐色 | RAL9010 Dust brown 鼠须褐色 | RAL9015 Te brown 茶褐色 | RAL9020 Mahogany brown 桃花心木褐色 | RAL9025 Chocolate brown 巧克力褐色 |
| | | | | | | | |
| RAL9030 Black brown 黑褐色 | RAL9035 Orange brown 橙黄褐色 | RAL9040 Sage brown 鼠须褐色 | RAL9045 Light brown 浅褐色 | RAL9050 Light brown 浅褐色 | RAL9055 (金鼠须) Pearl Copper Brown 珍珠铜褐色 | RAL9060 Color yellow 黄鼠须 | RAL9065 Grey 灰鼠须 |
| | | | | | | | |
| RAL9070 Signal black 信号黑 | RAL9075 Black ink 墨黑色 | RAL9080 White Blueblack Gray 白蓝黑灰 | RAL9085 Grey aluminum color 灰铝色 | RAL9090 Pure white 纯白色 | RAL9095 Blackite Black 石墨黑 | RAL9100 Saffron white 交黄白 | RAL9105 Signal black 信号黑 |
| | | | | | | | |
| RAL9110 (金鼠须) Metallic 珍珠灰 鼠须灰 | RAL9115 (金鼠须) Metallic 珍珠灰 鼠须灰 | RAL9120 (金鼠须) Metallic 珍珠灰 鼠须灰 | RAL9125 (金鼠须) Metallic 珍珠灰 鼠须灰 | RAL9130 (金鼠须) Metallic 珍珠灰 鼠须灰 | RAL9135 (金鼠须) Metallic 珍珠灰 鼠须灰 | RAL9140 (金鼠须) Metallic 珍珠灰 鼠须灰 | RAL9145 (金鼠须) Metallic 珍珠灰 鼠须灰 |

*同色色卡印刷有色差, 仅供参考, 实际以产品喷涂颜色为准。
*The pantone colour printing is only for reference, pls refer to actual products.

| | | | | | | | | |
|--|--|--|--|---|--|---|---|---|
|  RAL1000 Green beige 绿褐色 |  RAL1001 Beige 米色, 淡黄褐色 |  RAL1002 Sand yellow 沙黄色 |  RAL1003 Signal yellow 信号黄 |  RAL1004 Goldyellow 金黄色 |  RAL1005 Honey yellow 蜜黄色 |  RAL1006 Belted yellow 五金黄 |  RAL1007 Delicid yellow 淡黄色 |  RAL1011 Brown beige 棕褐色 |
|  RAL1012 Lemon yellow 柠檬黄 |  RAL1013 Distant white 远于白色的浅灰 |  RAL1014 Ivory 象牙色 |  RAL1015 Light ivory 浅象牙色 |  RAL1016 Sulfur yellow 硫磺色 |  RAL1017 Saffron yellow 深黄色 |  RAL1018 Zinn yellow 锡黄色 |  RAL1019 Grey beige 灰黄色 |  RAL1020 Olive yellow 橄榄黄 |
|  RAL1021 Base yellow 淡黄 |  RAL1023 Saffia yellow 交黄 |  RAL1024 Sabra yellow 绿黄色 |  RAL1026 Lustrous yellow 亮黄色 |  RAL1027 Curry 咖喱色 |  RAL1028 Bacon yellow 火腿黄 |  RAL1030 Broom yellow 黄菊花黄 |  RAL1033 Delia yellow 大野玫瑰黄 |  RAL1034 Petal yellow 粉黄色 |
|  RAL1035 (金黄) Pearl beige 珍珠褐色 |  RAL1036 (金黄) Pearl gold 金质珍珠 |  RAL1037 Sun yellow 日光黄 |  RAL1039 Tulip orange 黄橙色 |  RAL1040 Bliss red 喜悦 |  RAL1041 Vernal red 春红 |  RAL1043 Purpur orange 深橙 |  RAL1044 Pure orange 纯橙 |  RAL1045 Lustrous orange 亮橙 |
|  RAL1047 Lustrous bright orange 亮橙 |  RAL1048 Bright red orange 亮红橙 |  RAL1049 Saffia orange 交橙 |  RAL1010 Sageal orange 黄橙色 |  RAL1011 Deep orange 深橙色 |  RAL1012 Sage orange 桔色 |  RAL1013 (金黄) Pearl orange 珍珠橙 |  RAL1014 Pure red 大暗红 |  RAL1015 Signal red 信号红 |
|  RAL1016 Genuine red 真红 |  RAL1017 Ruby red 宝石红 |  RAL1018 Purple red 紫红色 |  RAL1019 Bliss red 喜悦红 |  RAL1020 Strawberry red 草莓红 |  RAL1021 Tuffia red 交暗红 |  RAL1022 (金黄) Purpur red 深暗红 |  RAL1023 Lustrous red 亮暗红 |  RAL1024 Signal red 信号红 |
|  RAL1025 Belique pink 浅粉红色 |  RAL1026 Light pink 淡粉红色 |  RAL1027 Doral red 暗粉红色 |  RAL1028 Bliss red 喜悦色 |  RAL1029 Strawberry red 草莓红 |  RAL1030 Tuffia red 交暗红 |  RAL1031 Broom pink 黄菊花粉 |  RAL1032 Lustrous red 亮暗红 |  RAL1033 Lustrous bright red 亮真红色 |
|  RAL1034 Raspberry red 覆盆子红色 |  RAL1035 Distant red 远暗红色 |  RAL1036 (金黄) Pearl ruby red 珍珠红宝石 |  RAL1037 (金黄) Pearl pink 珍珠粉色 |  RAL1038 Red lilac 丁香紫 |  RAL1039 Red violet 紫红色 |  RAL1040 Heather violet 石楠紫 |  RAL1041 Distant violet 远暗紫 |  RAL1042 Blue lilac 丁香蓝 |
|  RAL1043 Saffia purple 交紫 |  RAL1044 Purple violet 紫蓝色 |  RAL1045 Signal violet 信号紫罗兰 |  RAL1046 Petal violet 花瓣紫 |  RAL1047 emerald 电绿品红色 |  RAL1048 (金黄) Pearl violet 珍珠紫 |  RAL1049 Pearl blackberry 珍珠黑 |  RAL1050 Violet blue 紫蓝色 |  RAL1051 Green blue 蓝绿色 |
|  RAL1052 Sapphire blue 蓝宝石 |  RAL1053 Slate blue 深蓝色 |  RAL1054 Slate blue 深蓝色 |  RAL1055 Signal blue 信号蓝 |  RAL1056 Brilliant blue 亮蓝色 |  RAL1057 Grey blue 灰蓝色 |  RAL1058 Azore blue 天蓝色 |  RAL1059 Berlin blue 柏林蓝色 |  RAL1060 Steel blue 钢蓝色 |
|  RAL1061 Light blue 淡蓝色 |  RAL1062 Distant blue 远蓝色 |  RAL1063 Pigeon blue 鸽蓝色 |  RAL1064 Sky blue 天蓝色 |  RAL1065 Tuffia blue 交蓝 |  RAL1066 Turquoise blue 绿松石蓝 |  RAL1067 Dart blue 少年蓝绿色 |  RAL1068 Ocean blue 海蓝色 |  RAL1069 Water blue 水鸭蓝色 |
|  RAL1070 Night blue 夜蓝色 |  RAL1071 Distant blue 远蓝色 |  RAL1072 Petal blue 花瓣蓝色 |  RAL1073 (金黄) Pearl gentian blue 珍珠天竺葵 |  RAL1074 (金黄) Pearl eight blue 珍珠夜蓝 |  RAL1075 Patina green 铜绿棕色 |  RAL1076 Sward green 草绿棕色 |  RAL1077 Leaf green 叶绿色 |  RAL1078 Olive green 橄榄绿 |



江苏亿能电气有限公司

JIANGSU YINENG ELECTRIC CO., LTD.

地址：江苏省扬州市湾巷路508号(沿江工业集中区)

电话：0511-88455999 88450116

传真：0511-88330556

电邮：yineng@jyineng.com 邮编：212213